

FREIGHT LINE - MILWAUKEE TO ELM GROVE

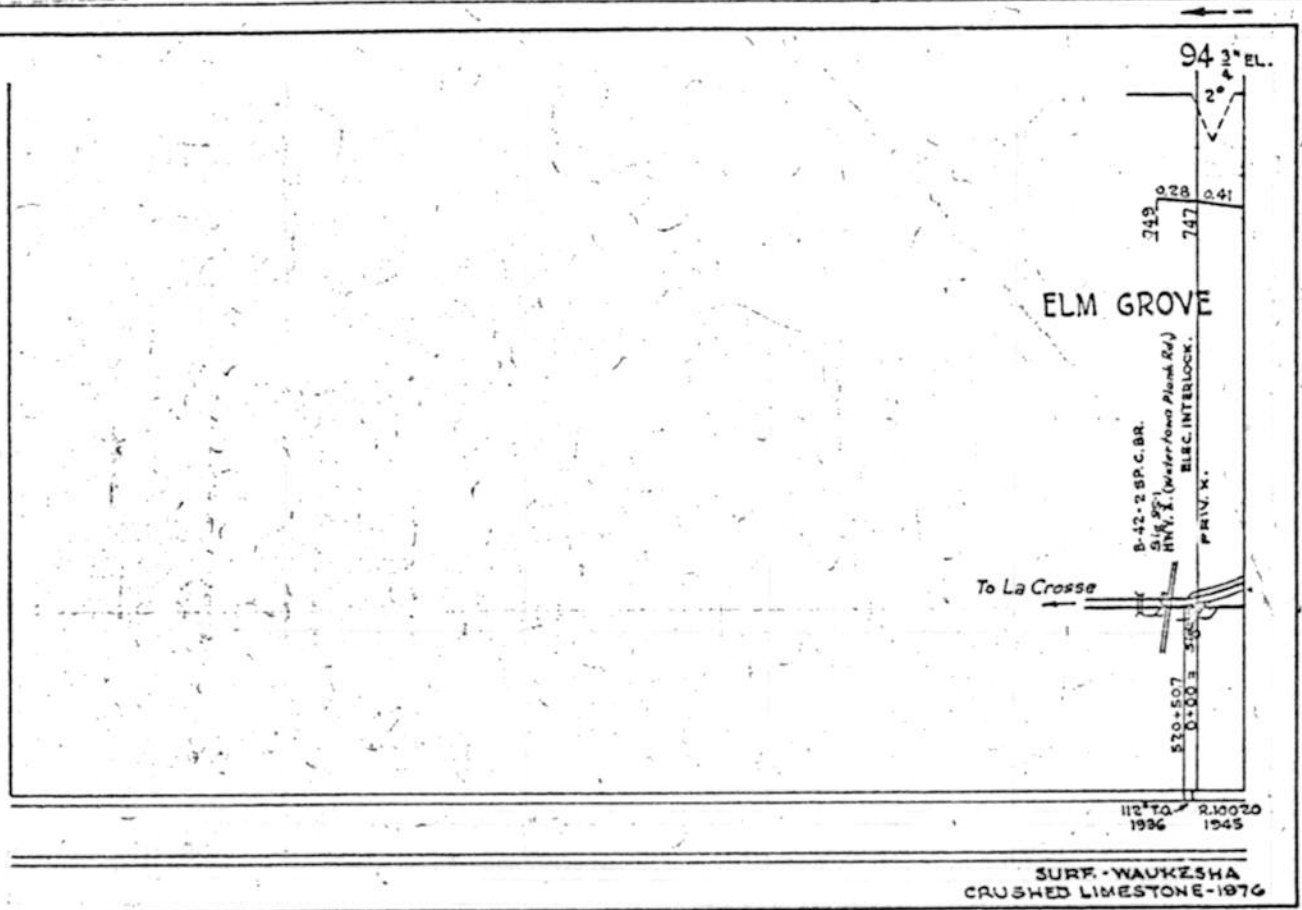

AUTOMATIC BLOCK SYSTEM

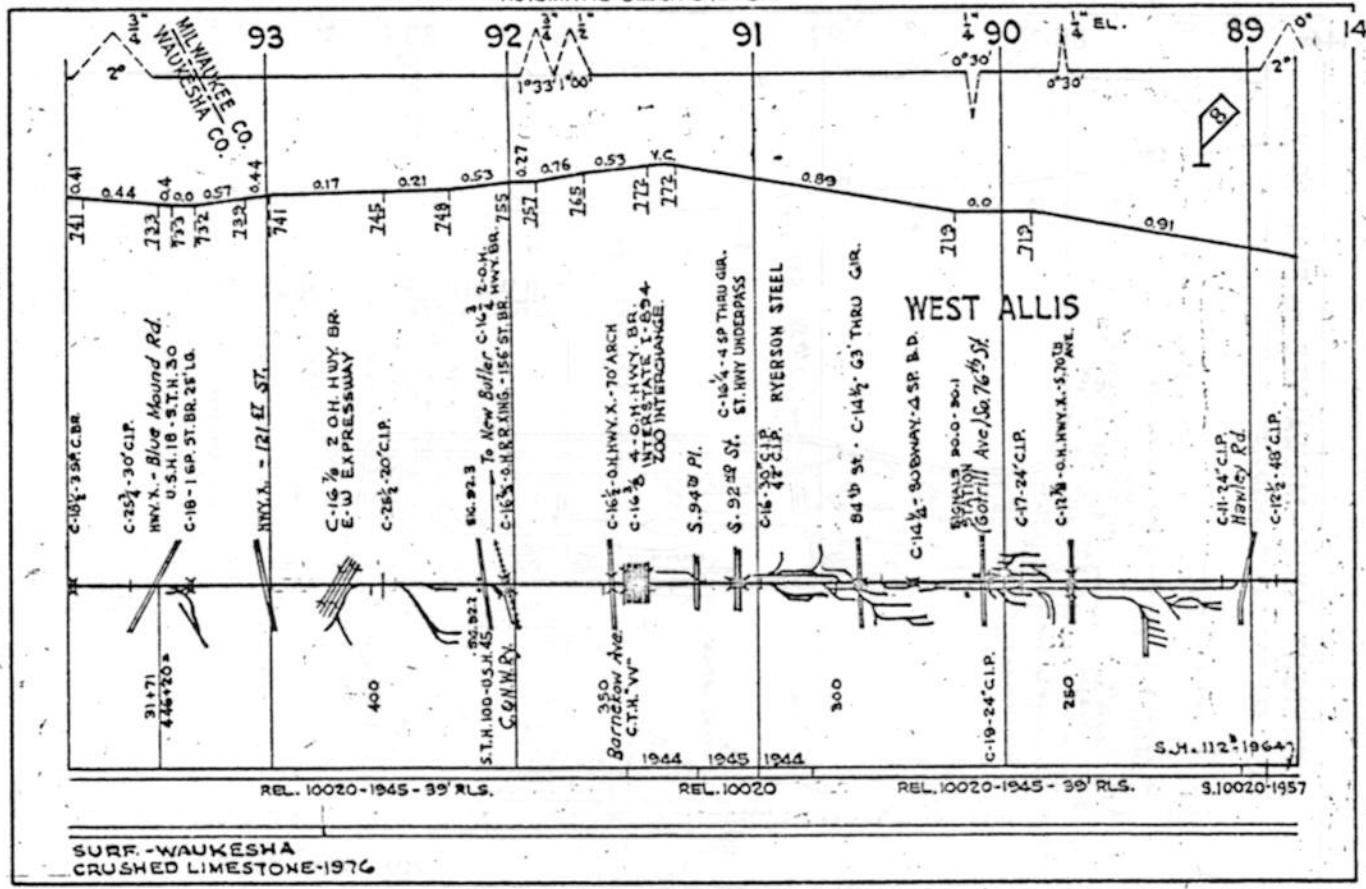

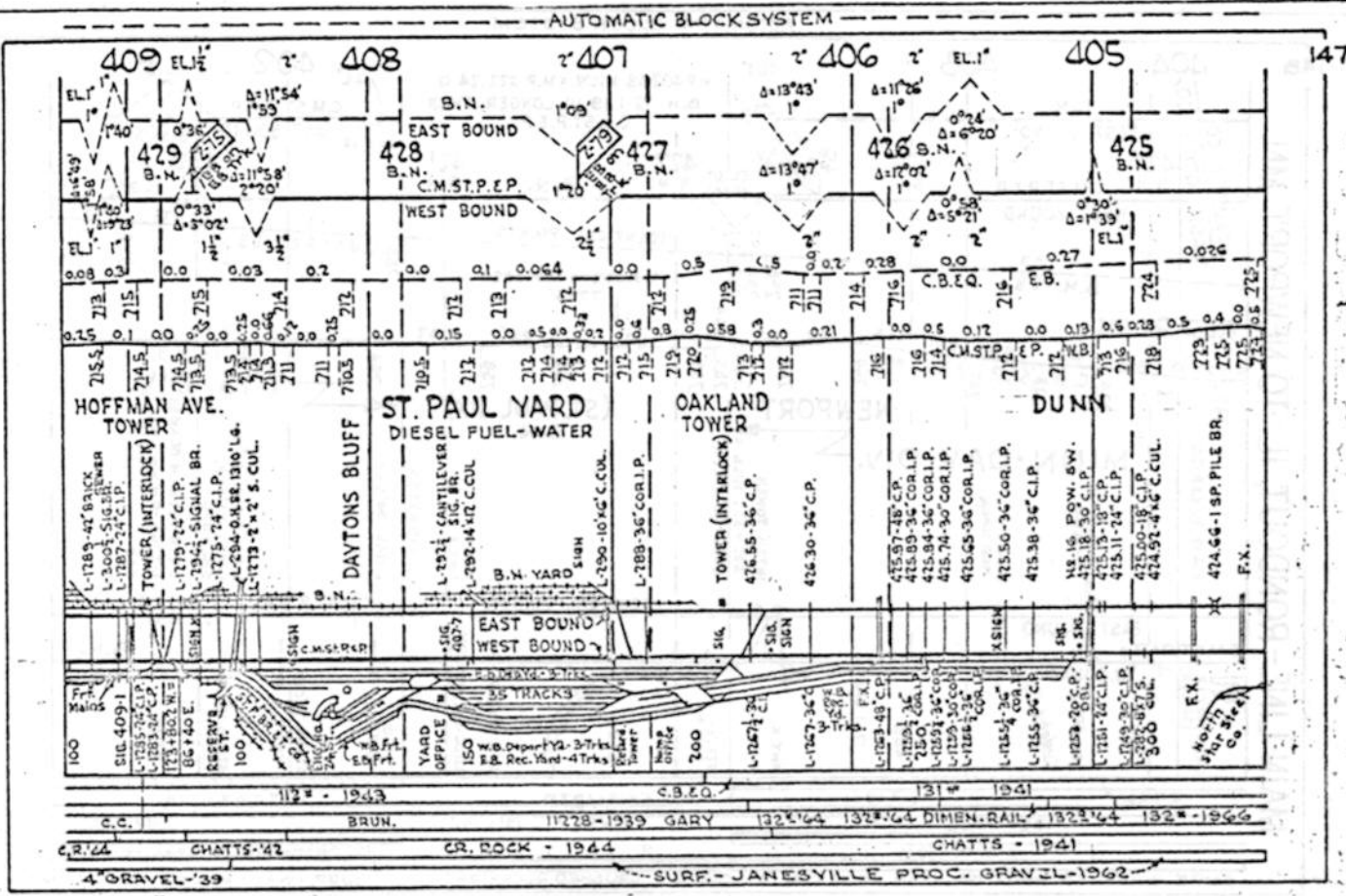
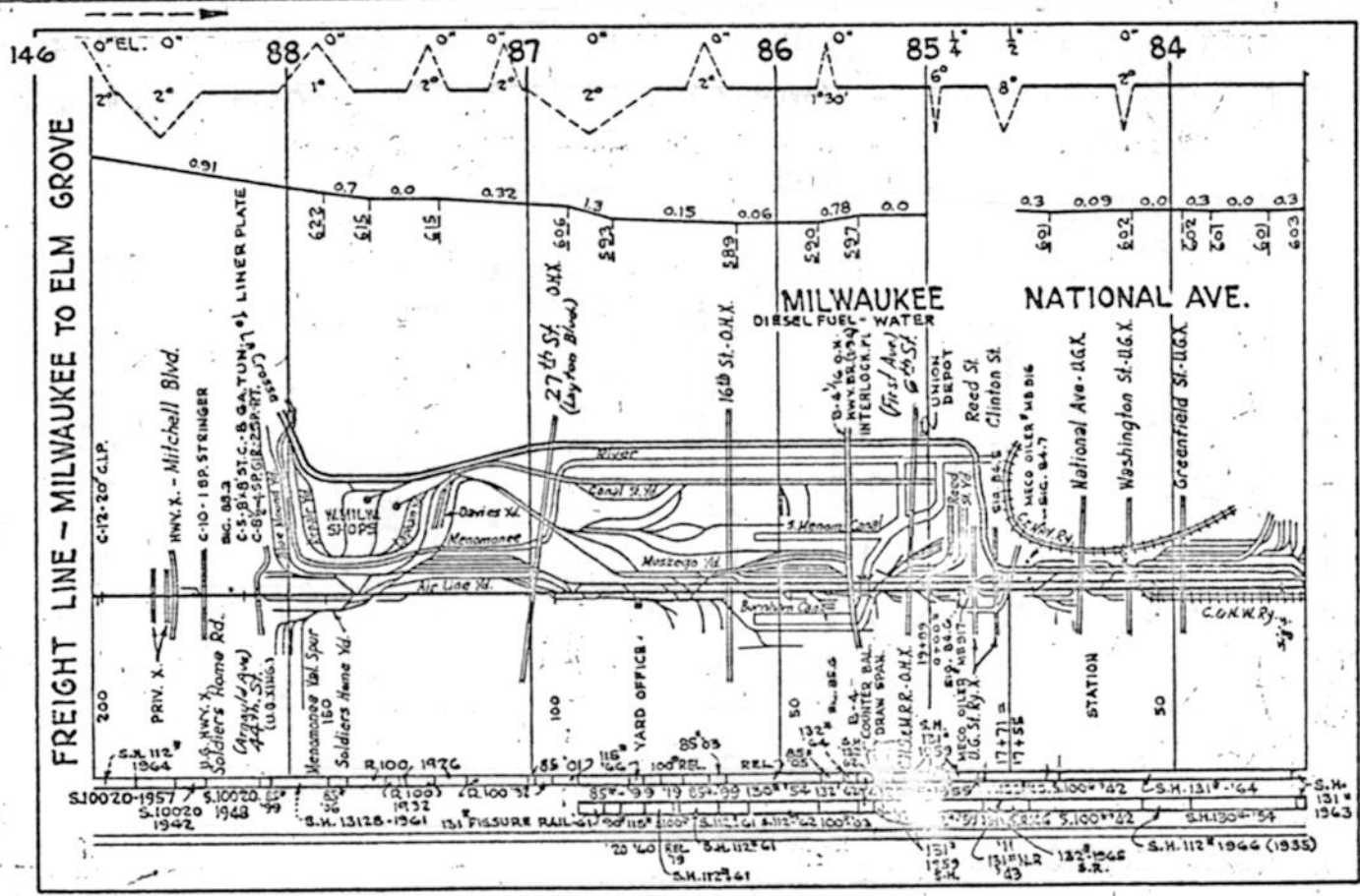

4 GRAVEL - 39 SURF - JANESVILLE PROC. GRAVEL - 1962

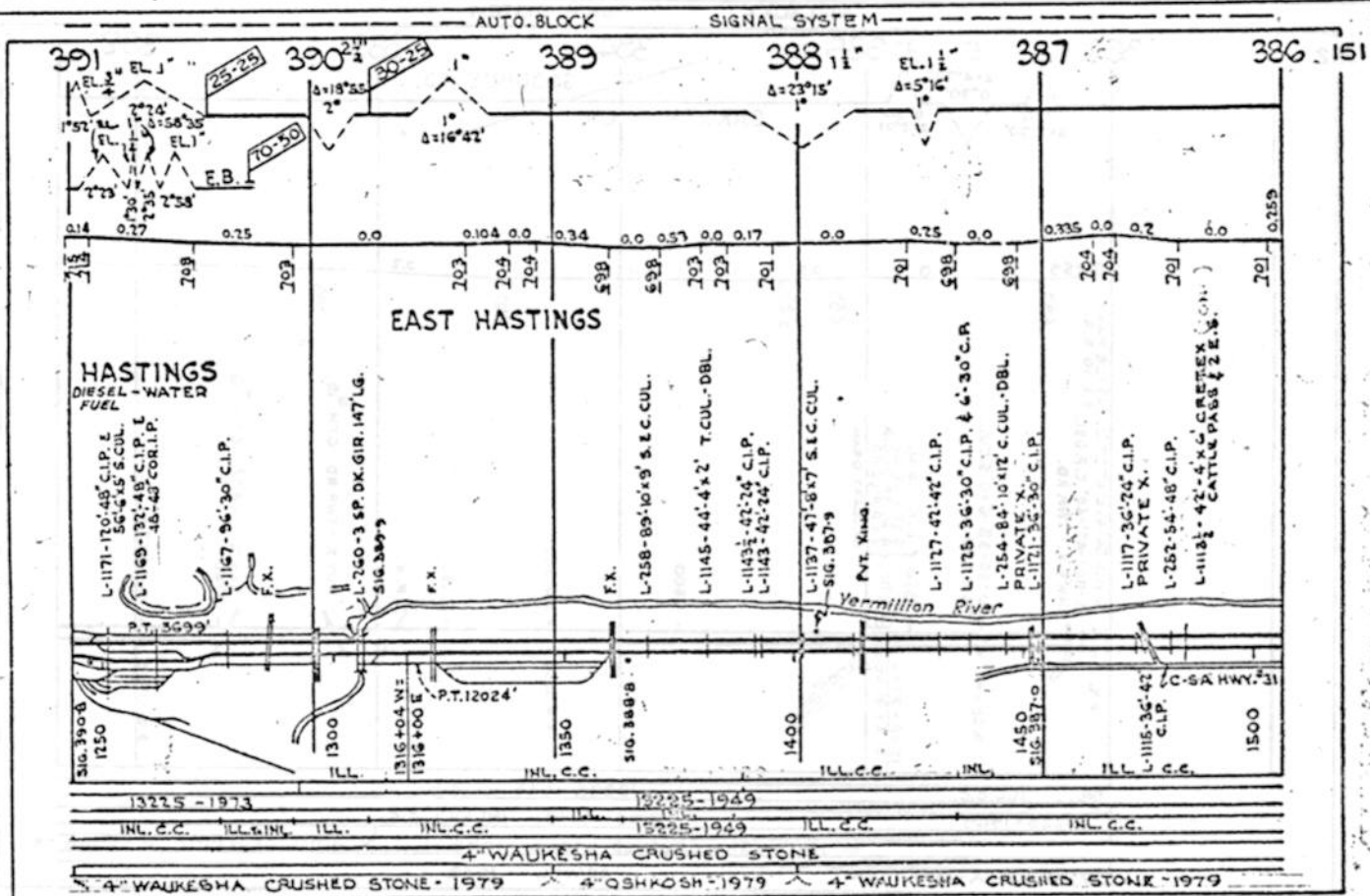
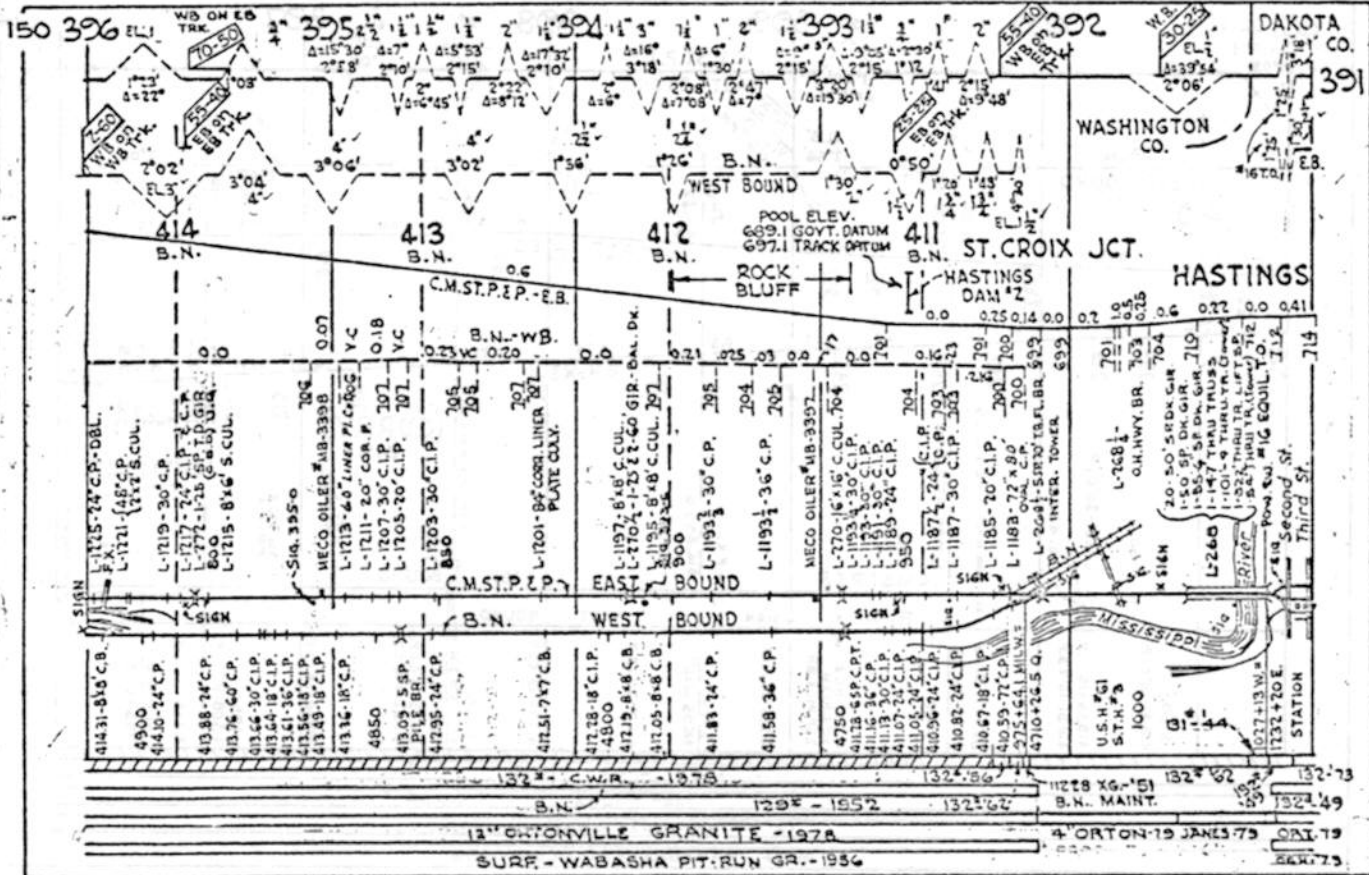

154

EL. 2' 376

375

374

373 4'

372 EL. 1 1/2'

70-50

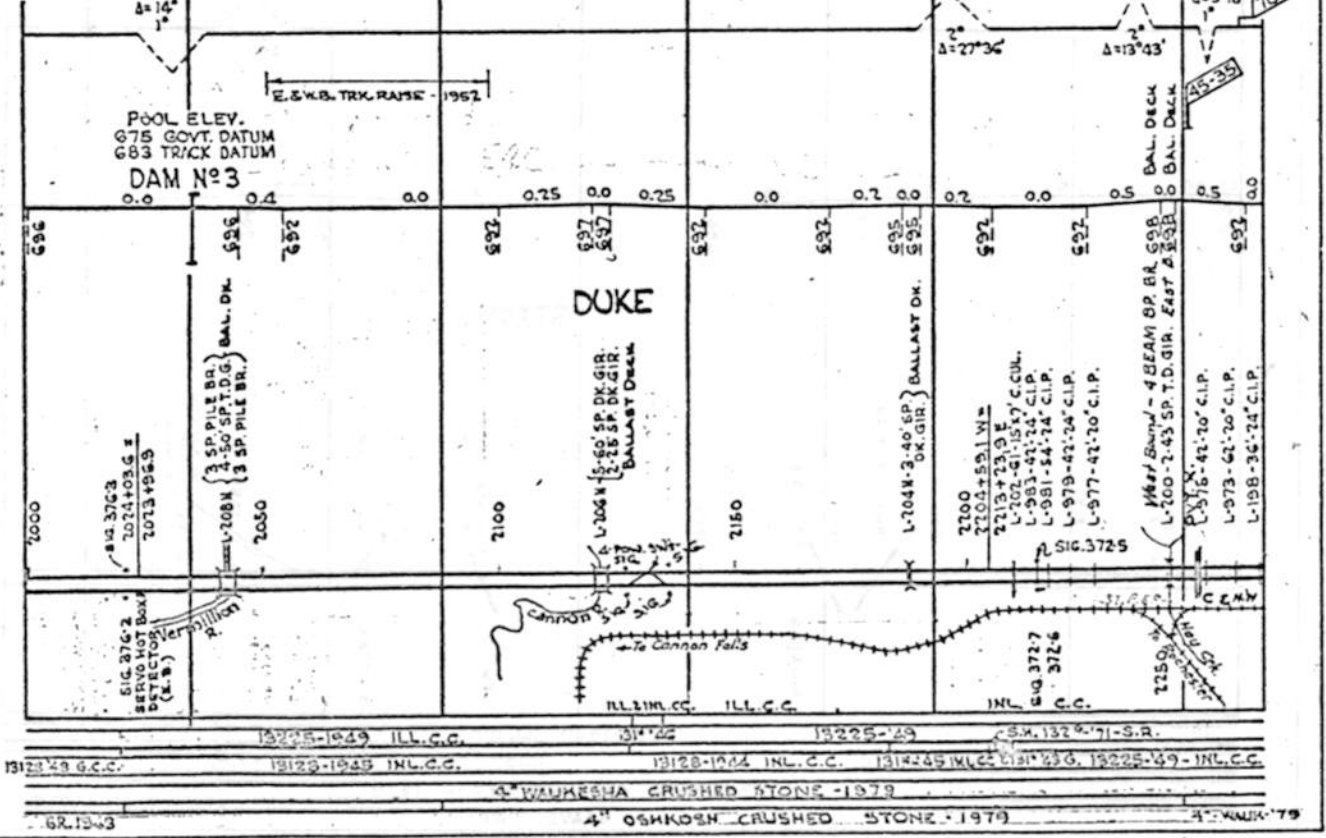

155

EL. 2' 371

370

369

368

EL. 1' 367

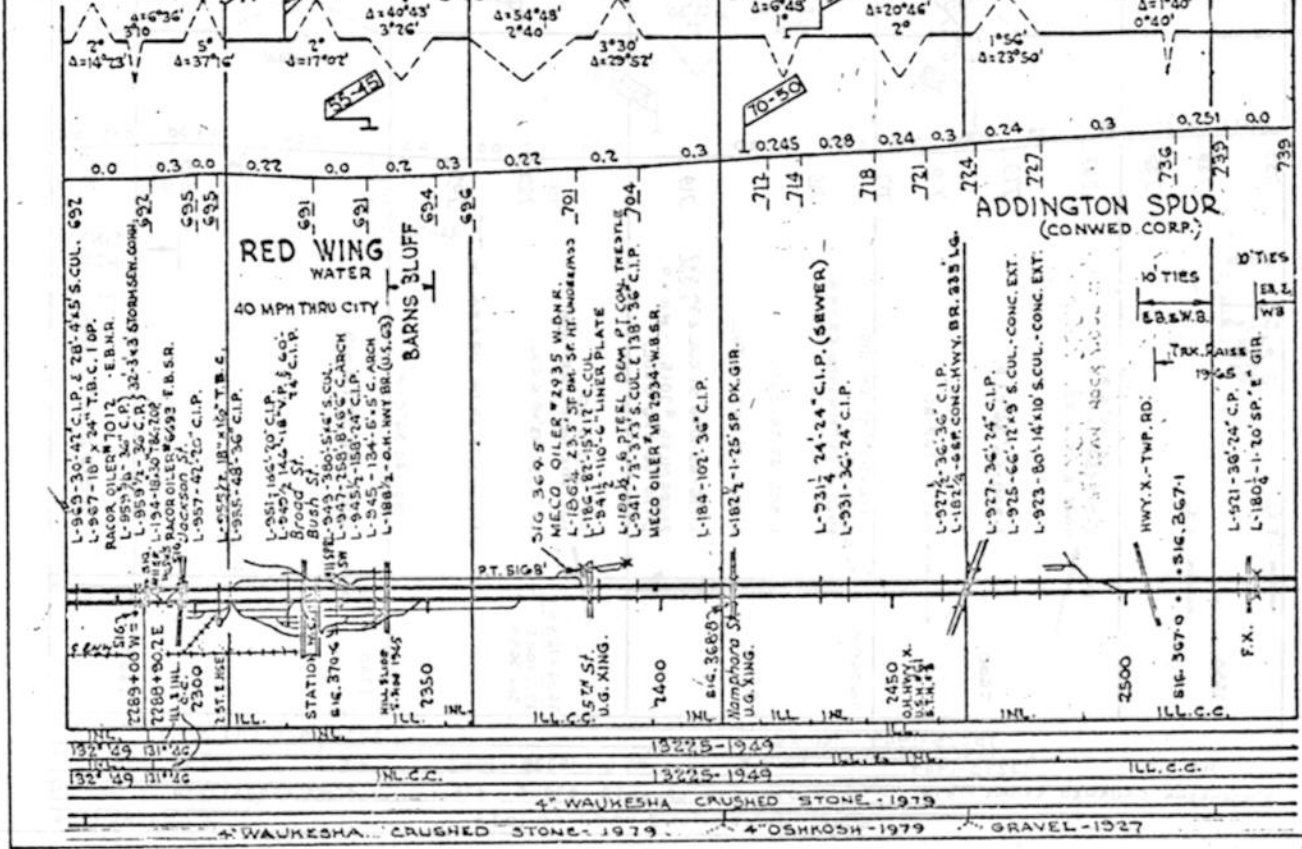

156

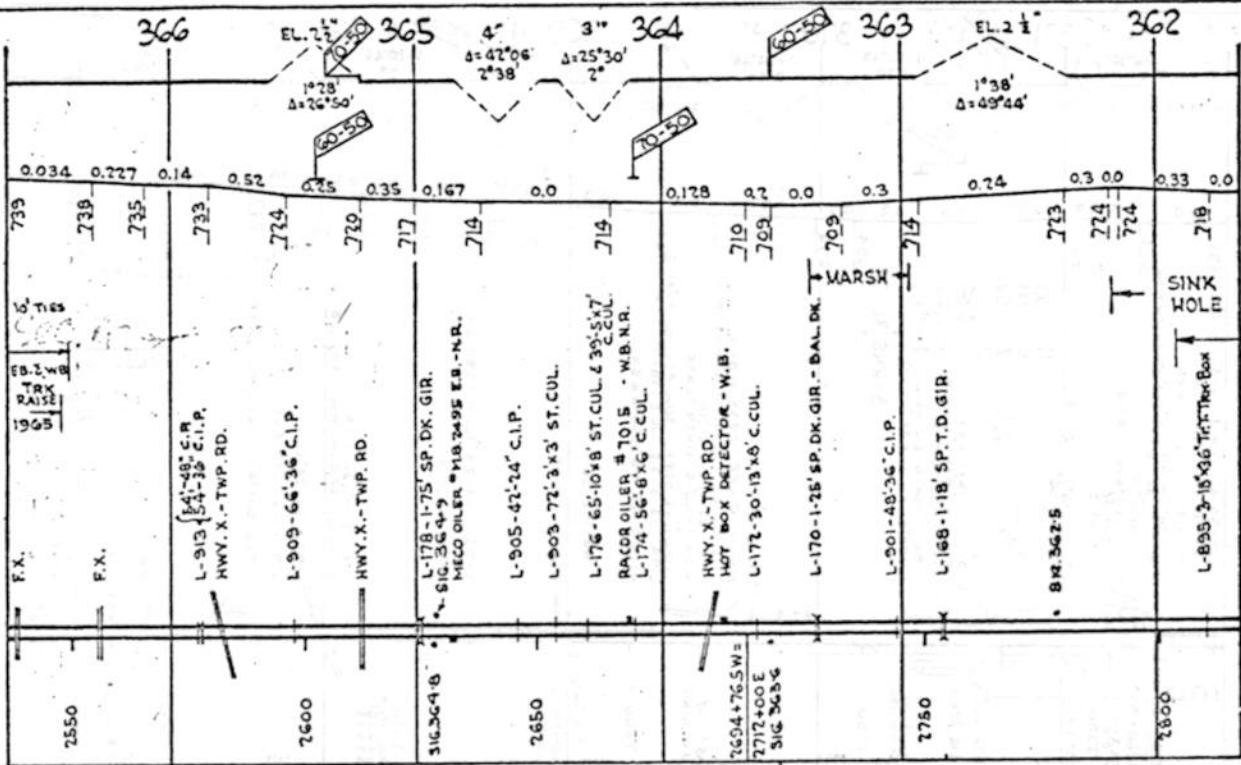

13225-1949	ILL. C.C.	13225-1949	ILL. C.C.	ILL. C.C. 13225-1952	H.C.	13225-1953
4" WAUKESHA CRUSHED STONE - 1979	4" OSHKOSH CRUSHED STONE - 1979	4" WAUKESHA - 1979	4" WAUKESHA - 1979	4" WAUKESHA - 1979	4" WAUKESHA - 1979	4" WAUKESHA - 1979
SURF. - JANEVILLE PROC. GR. - 1974				4" GRAVEL 1936		

157

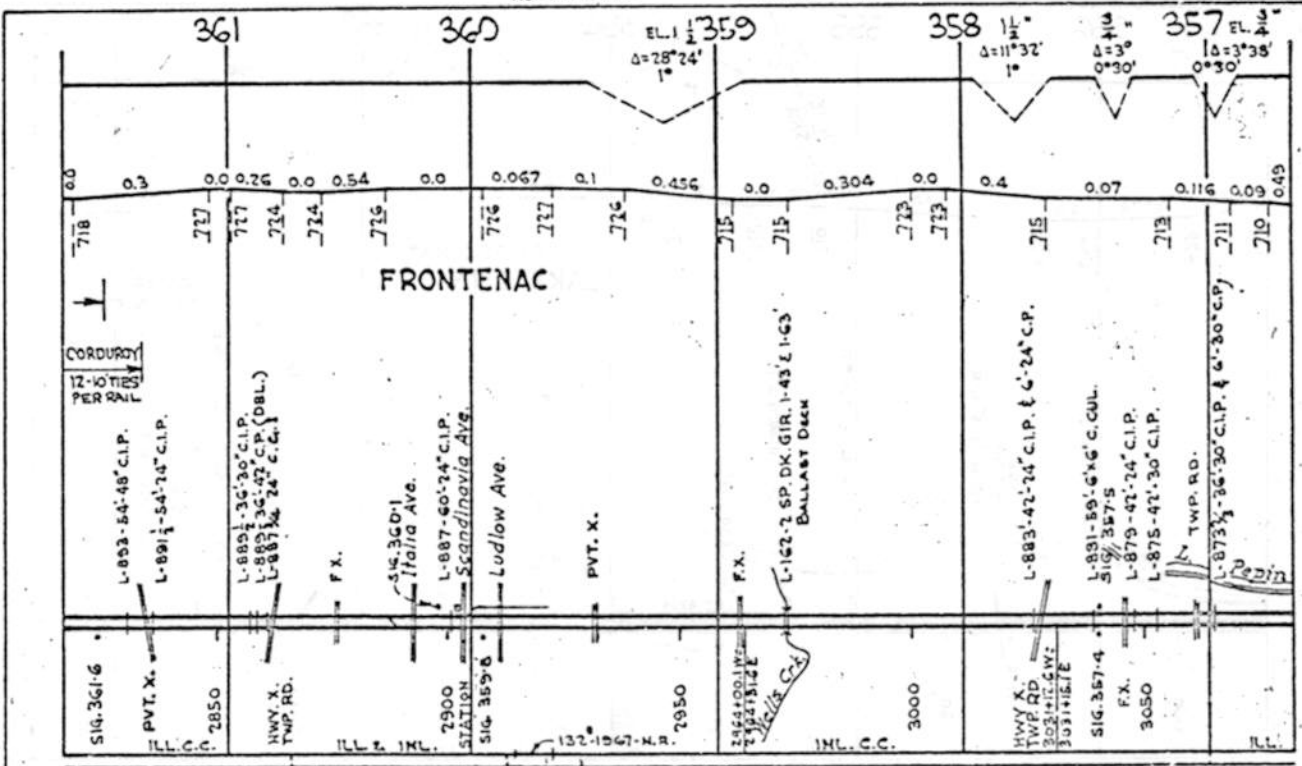

13225-1953	13225-1973	13225-1943 (ILL. C.C.)
4" OSHKOSH - 79	4" WAUKESHA CRUSHED STONE - 1979	4" WAUKESHA CRUSHED STONE - 1979
4" GRAVEL 1936		SURF. - WABASHA FIT-RUN GR. - 1956

158

356

355

354

353

352

EL. 702

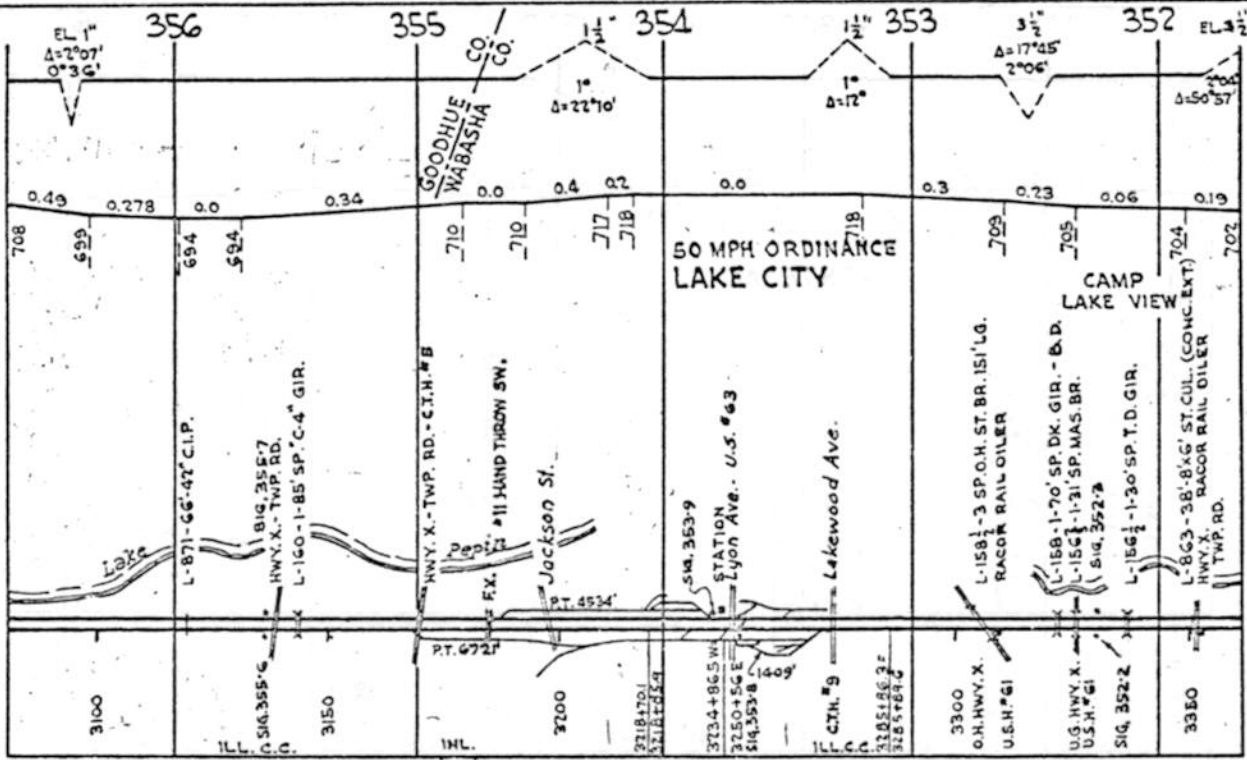

50 MPH ORDINANCE
LAKE CITY

CAMP
LAKE VIEW

GOODHUE
WABASHA
CO. CO.

HWY. X - TWP. RD. - C.T.H. # B
FX. 11 HUND THRON SW.
Jackson St.

STATION
Lyon Ave. - U.S. # 63

L-158-1-3 SP. O.H. ST. BR. 151' LG.
RACOR RAIL OILER

L-158-1-70' SP. DK. GIR. - B.D.
L-154-1-31' SP. MAS. BR.
SIG. 352-2

L-154-1-30' SP. T.D. GIR.
L-863-38' 8x6' ST. CUL. (CONC. EXT.)
HWY. X. RACOR RAIL OILER
TWP. RD.

3100

3150

3200

3250

3300

3350

3400

3450

13225-1948
 ILL. C.C. 13223-1948 13227-76 ILL. C.C. INL. C.C.
 4" WAUKESHA CRUSHED STONE - 1979
 4" OSHKOSH - CRUSHED STONE - 1979
 4" OSHKOSH - 7.9 4" WAUKESHA - 1979 4" OSHKOSH - CRUSHED STONE - 1979 4" OSHKOSH - 7.9

32,190 C.Y. RIP RAP 1942

AUTO. BLOCK

SIGNAL SYSTEM

159

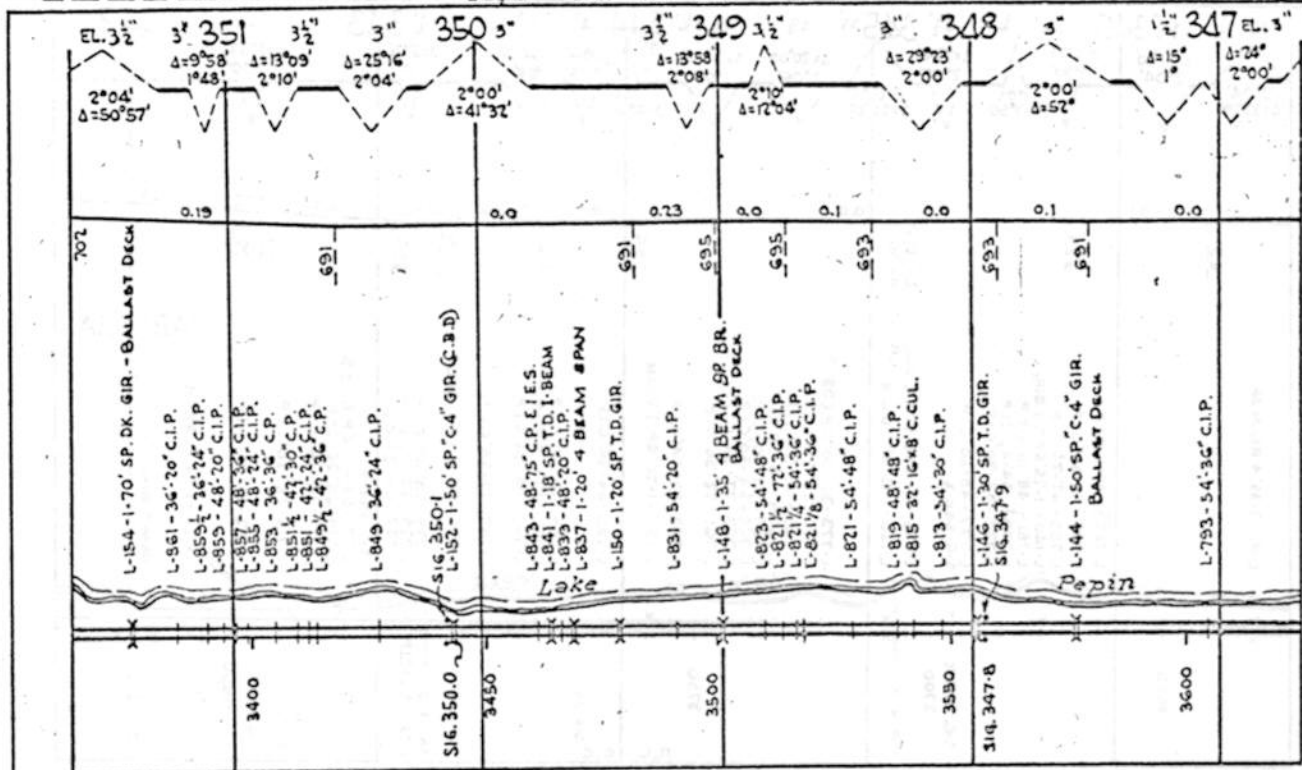

702

691

691

695

695

693

693

L-154-1-70' SP. DK. GIR. - BALLAST DECK
L-861-36°20' C.I.P.
L-859-1-16°14' C.I.P.
L-859-48°20' C.I.P.
L-859-48°20' C.I.P.
L-853-48°24' C.I.P.
L-853-36°36' C.P.
L-851-41°30' C.P.
L-851-41°30' C.P.
L-849-41°36' C.P.

L-849-36°24' C.I.P.
SIG. 350-1
L-152-1-50' SP. C.4" GIR. (C.B.B.)

L-843-48°75' C.P. I.E.S.
L-841-1-18' SP. T.D. I-BEAM
L-839-48°20' C.I.P.
L-837-1-20' 4 BEAM SPAN
L-150-1-70' SP. T.D. GIR.
L-831-54°20' C.I.P.

L-148-1-35' 4 BEAM SP. BR.
BALLAST DECK
L-823-54°48' C.I.P.
L-821-72°36' C.I.P.
L-821-54°36' C.I.P.
L-821-54°36' C.I.P.

L-819-48°48' C.I.P.
L-815-32°15' 8' C.CUL.
L-813-54°30' C.I.P.

L-145-1-30' SP. T.D. GIR.
SIG. 347-9

L-144-1-50' SP. C.4" GIR.
BALLAST DECK
L-793-54°36' C.I.P.

13225-1948
 INL. C.C. 13223-1948 ILL. C.C.
 4" WAUKESHA CR. STONE - 1979 4" OSHKOSH - 1979 4" WAUKESHA CRUSHED STONE - 1979
 4" GRAVEL 1948 (WABASHA PIT-RUN)

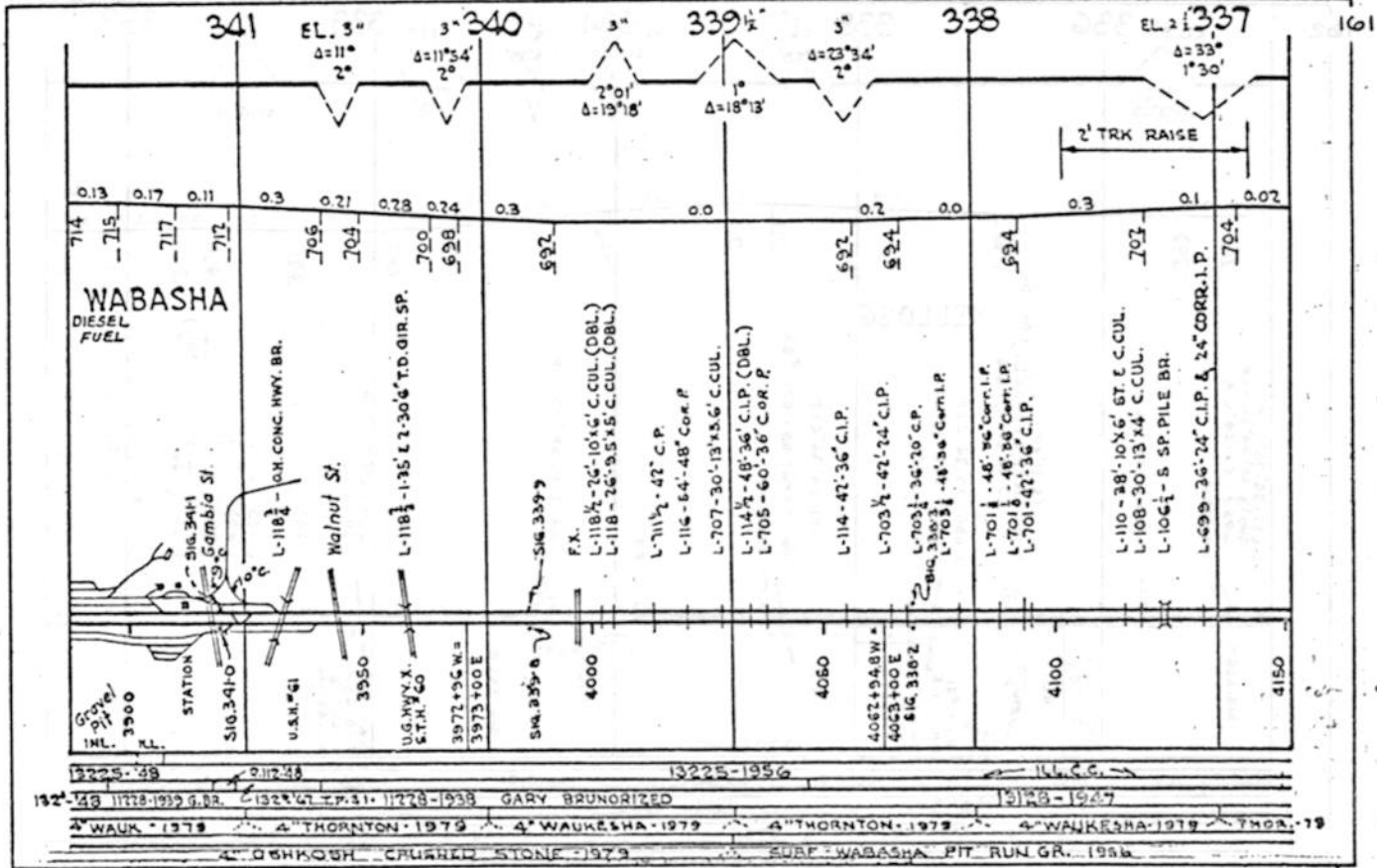
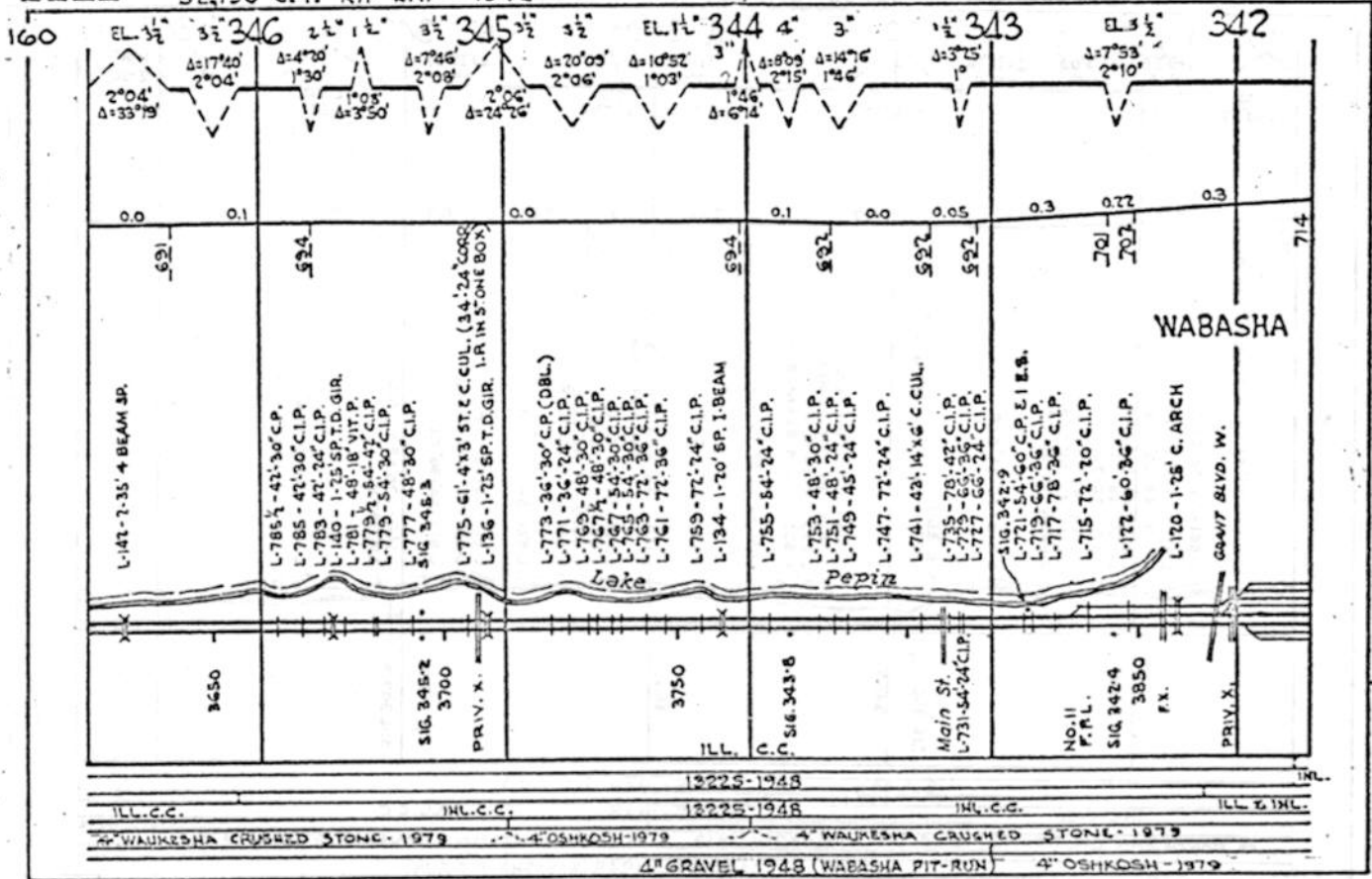

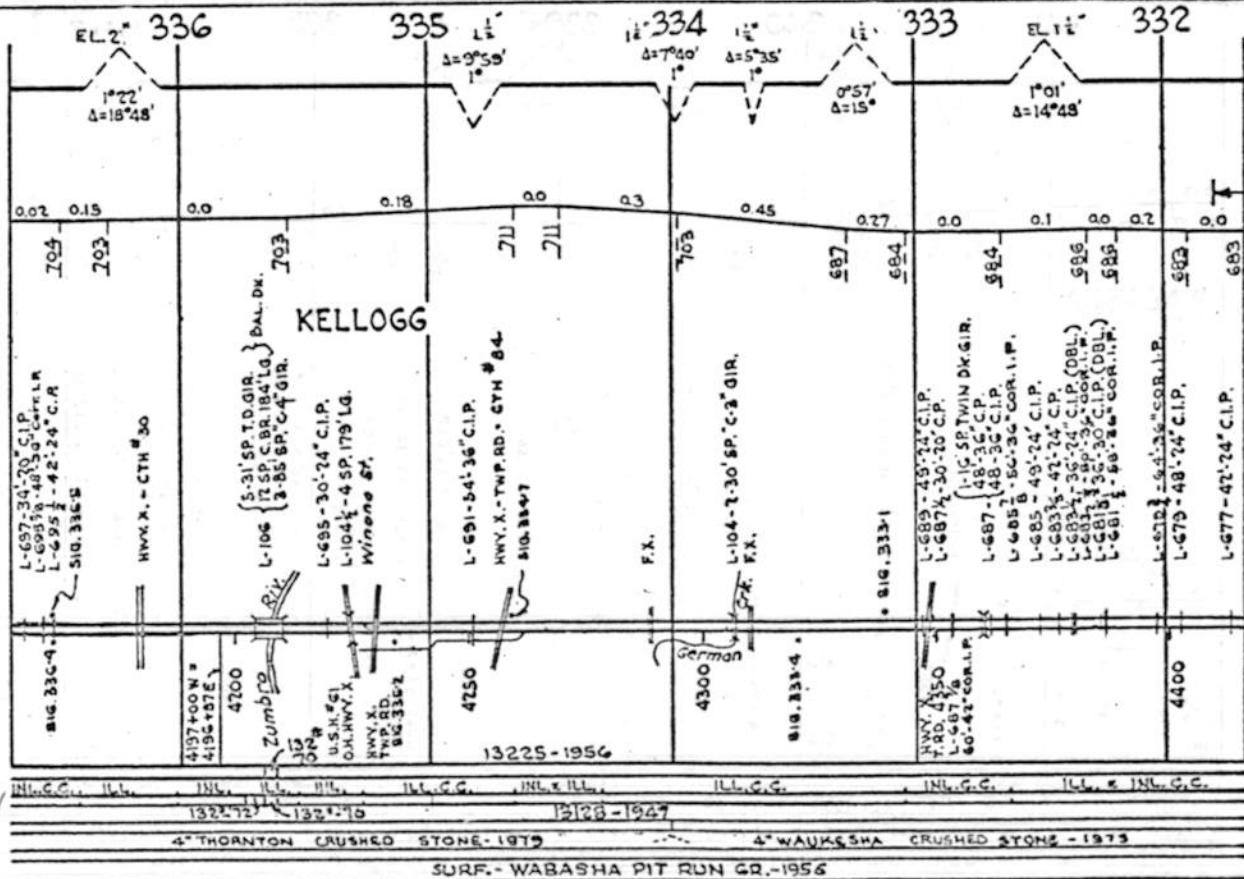

AUTO.BLOCK- SIGNAL SYSTEM

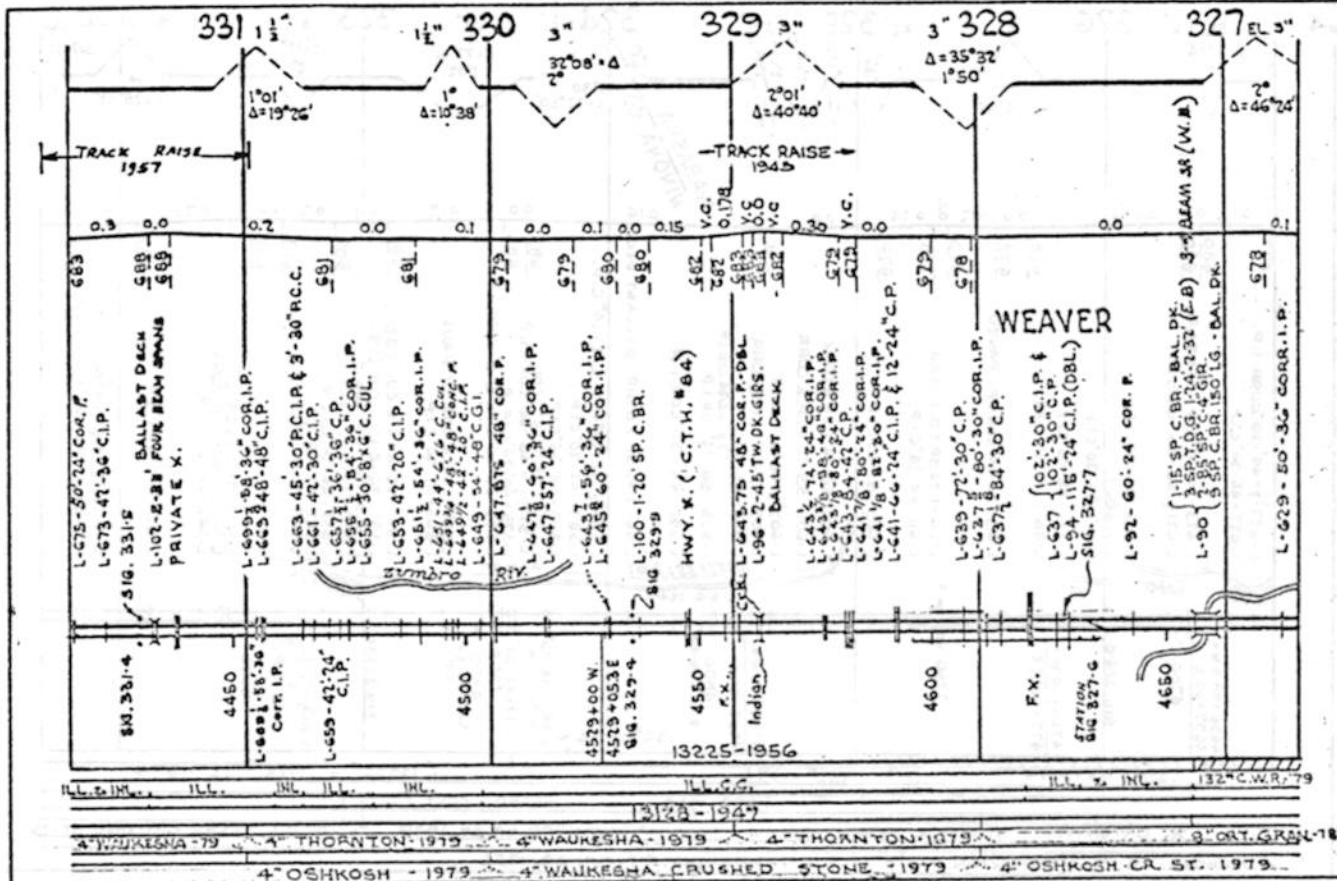

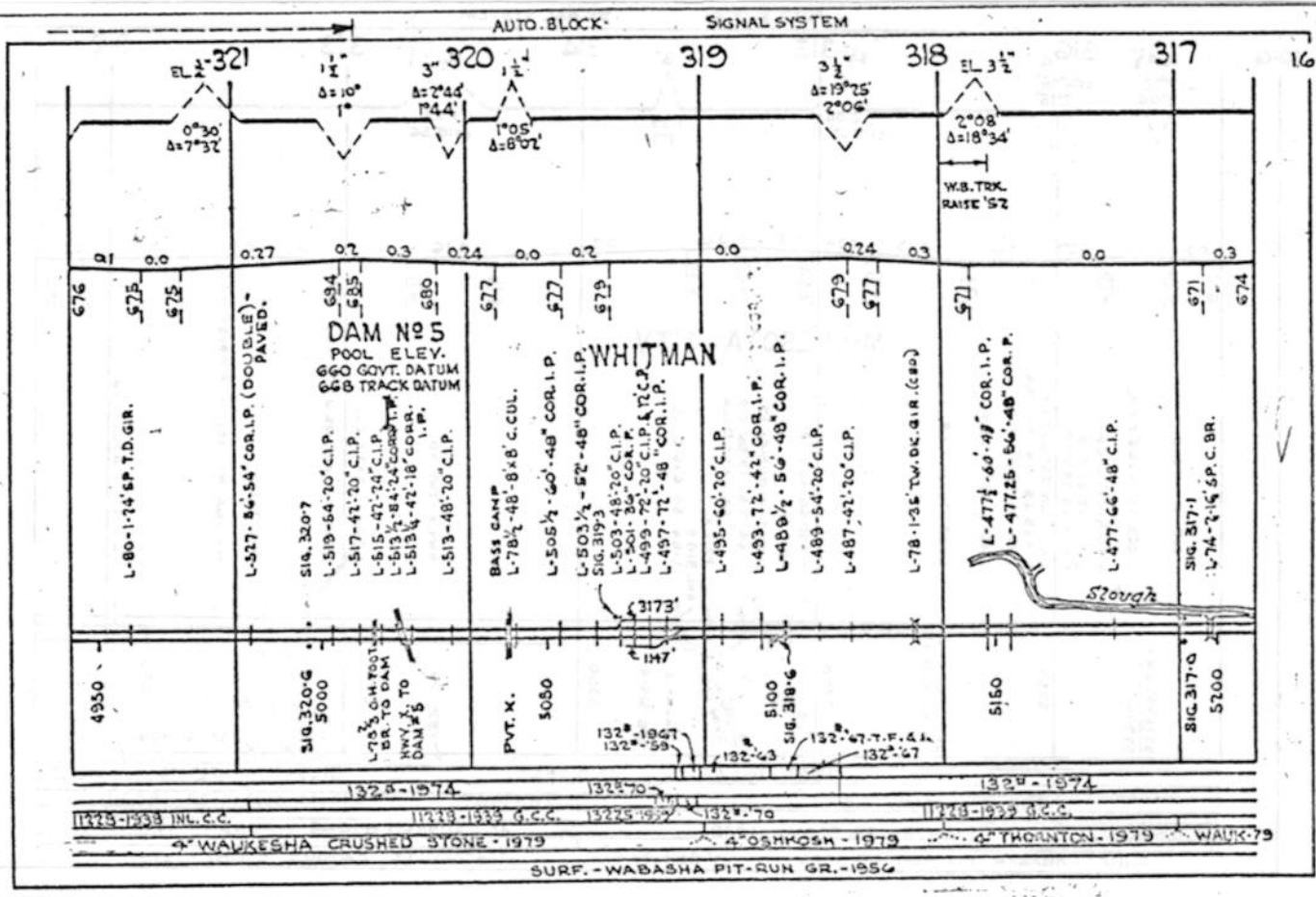
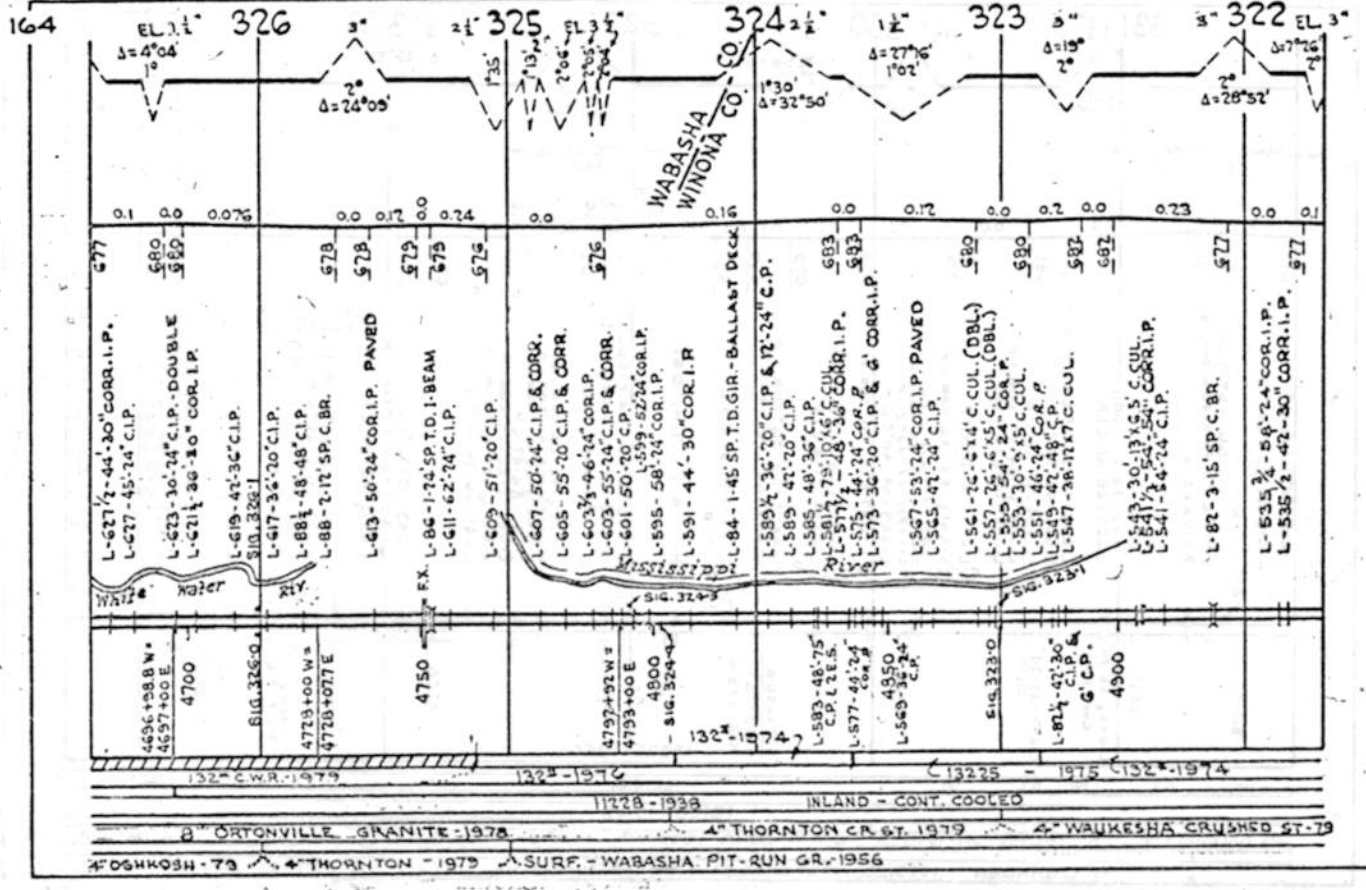

170

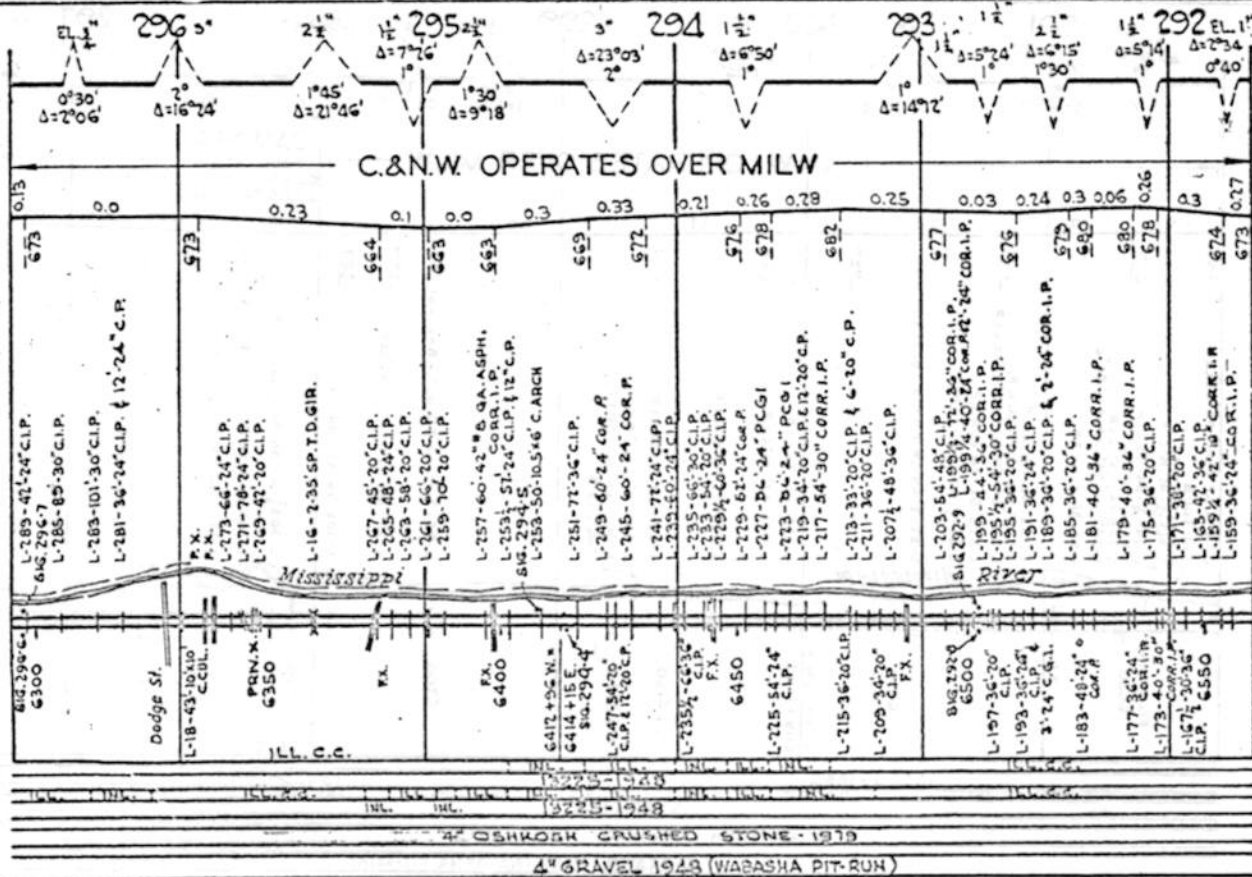

171

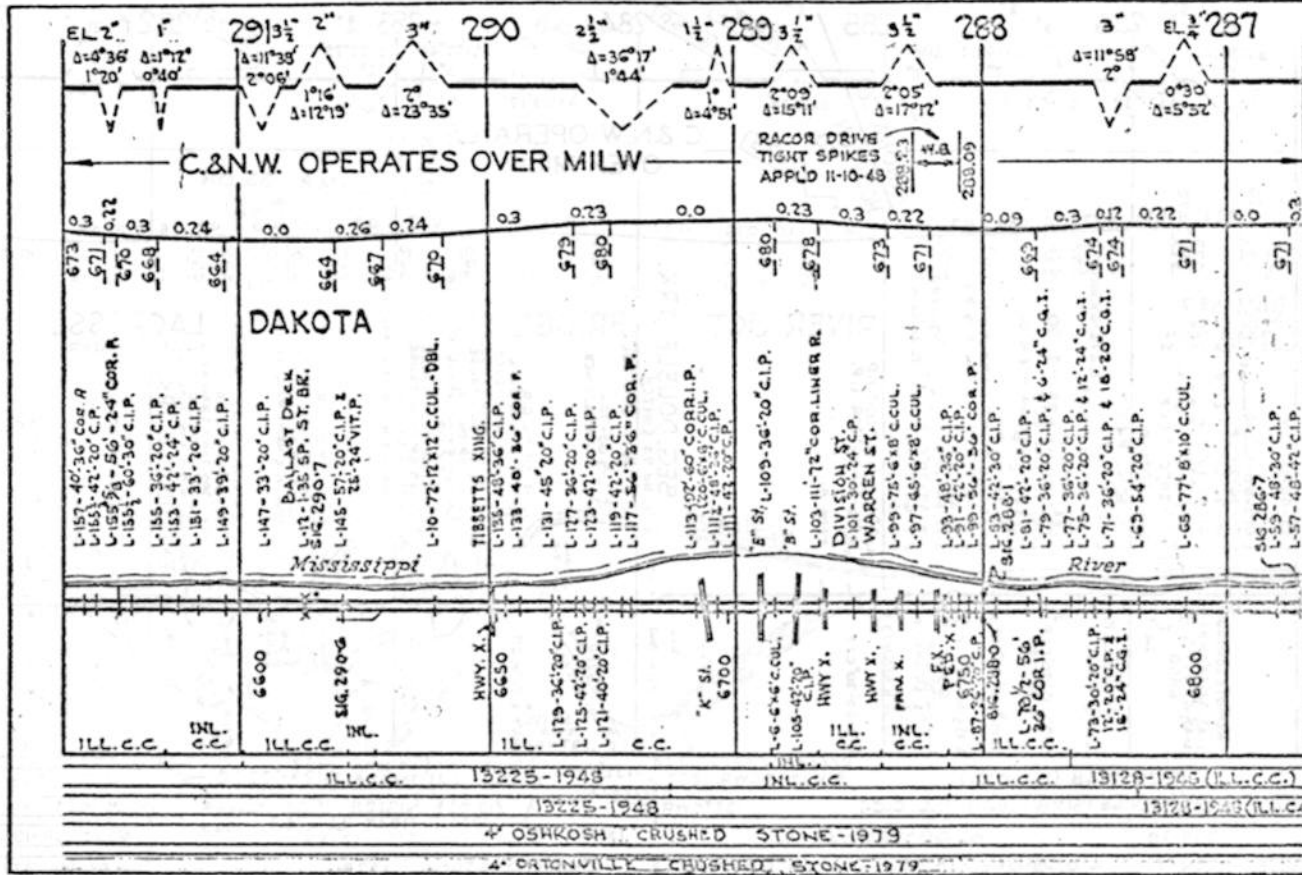

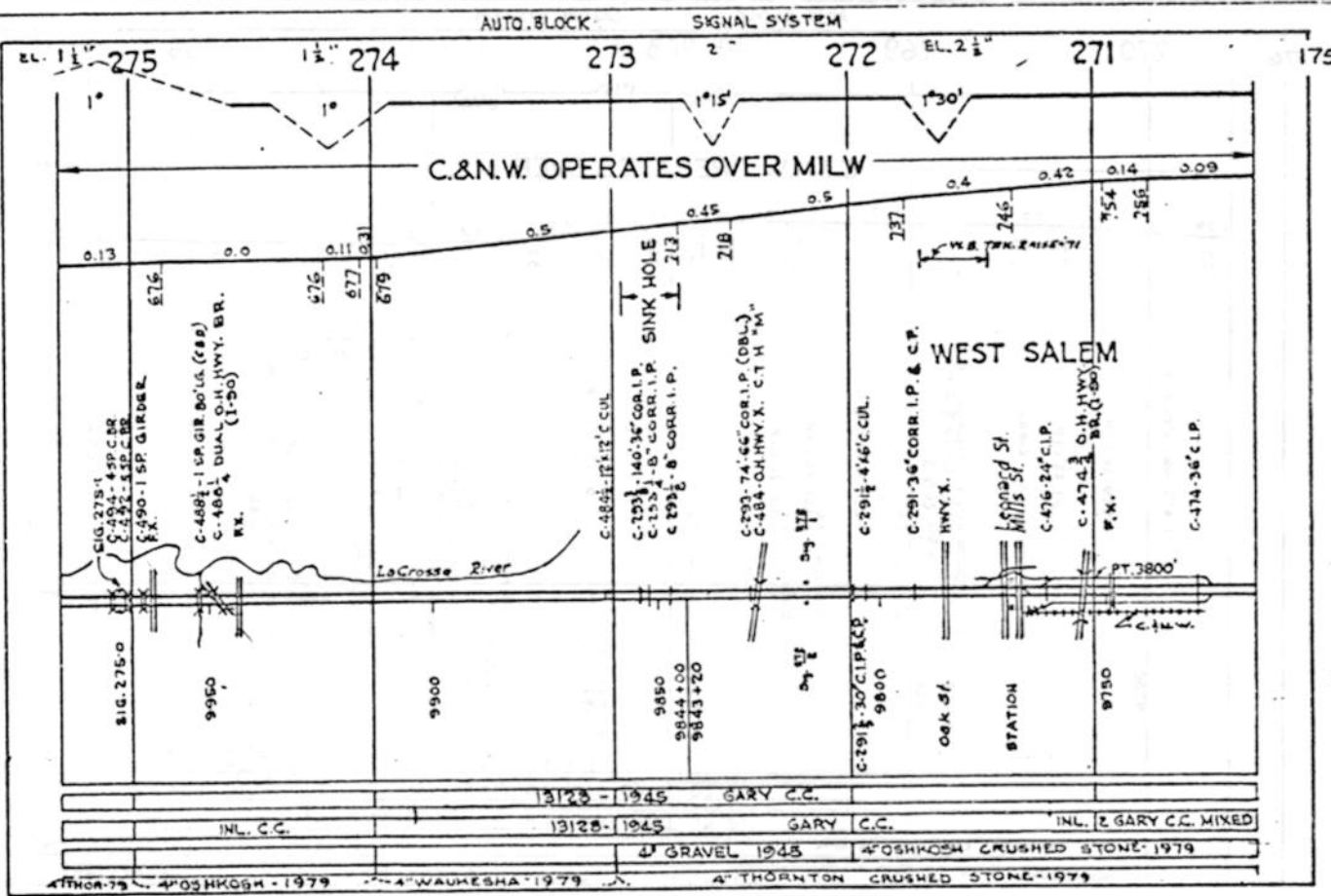
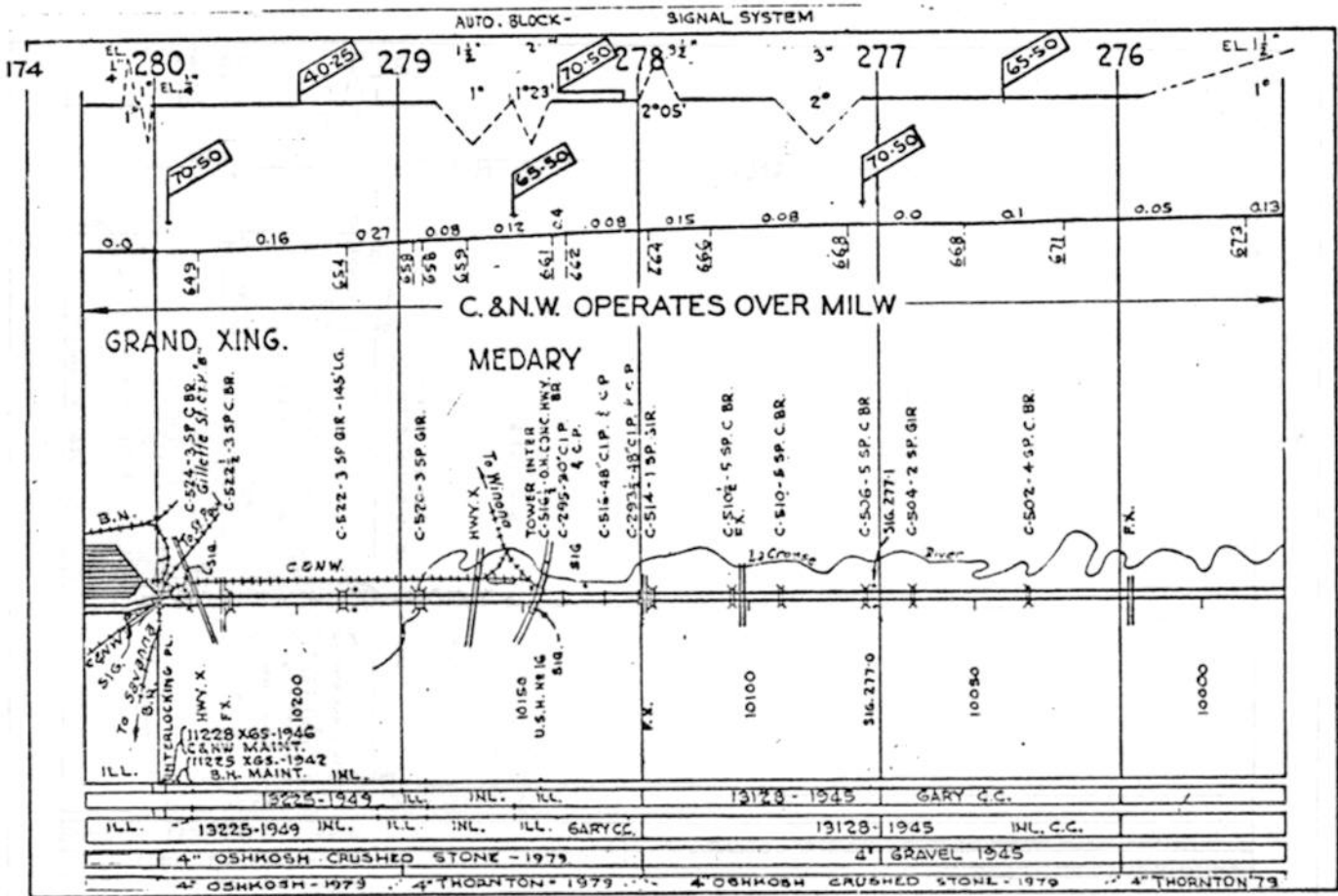

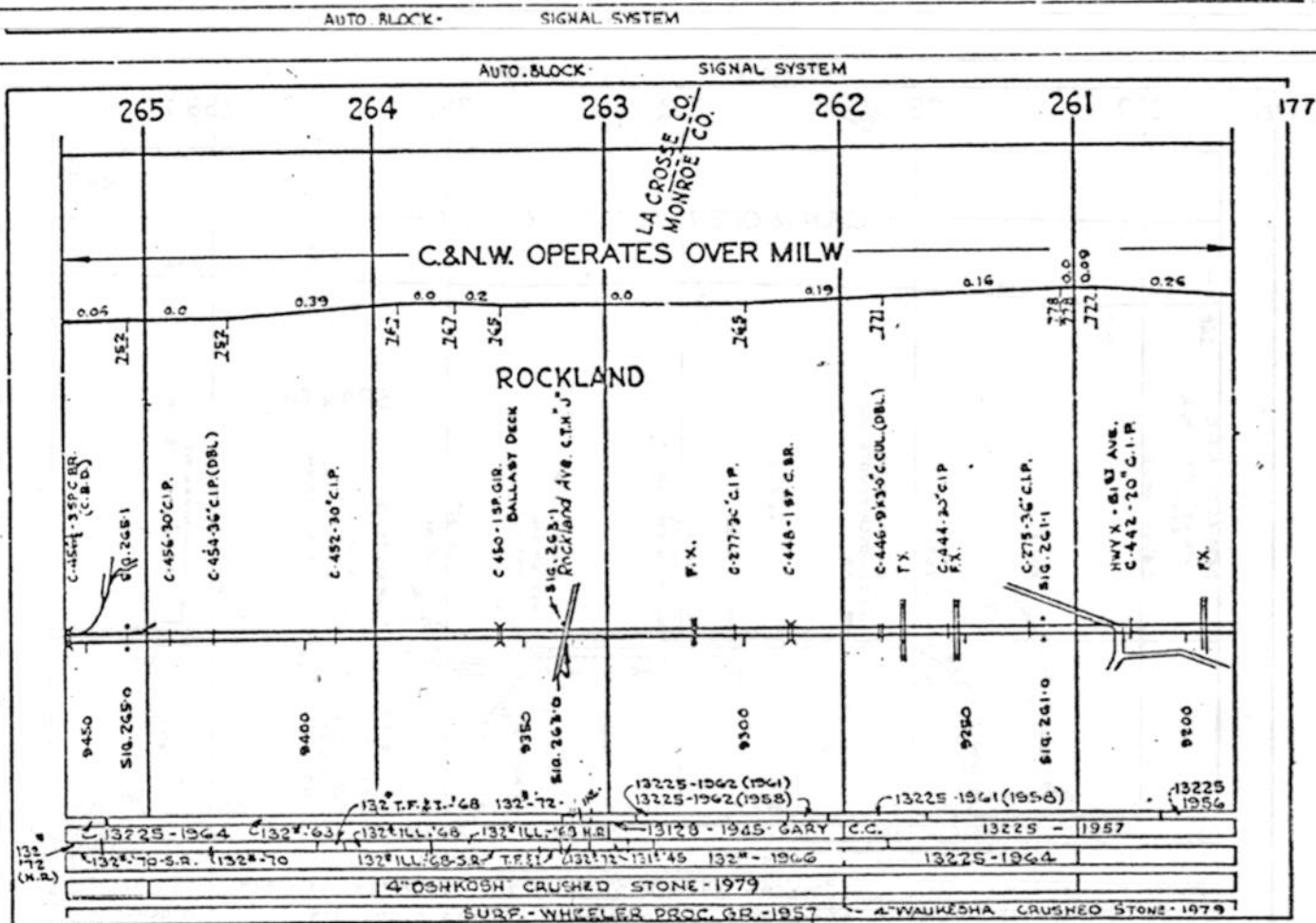
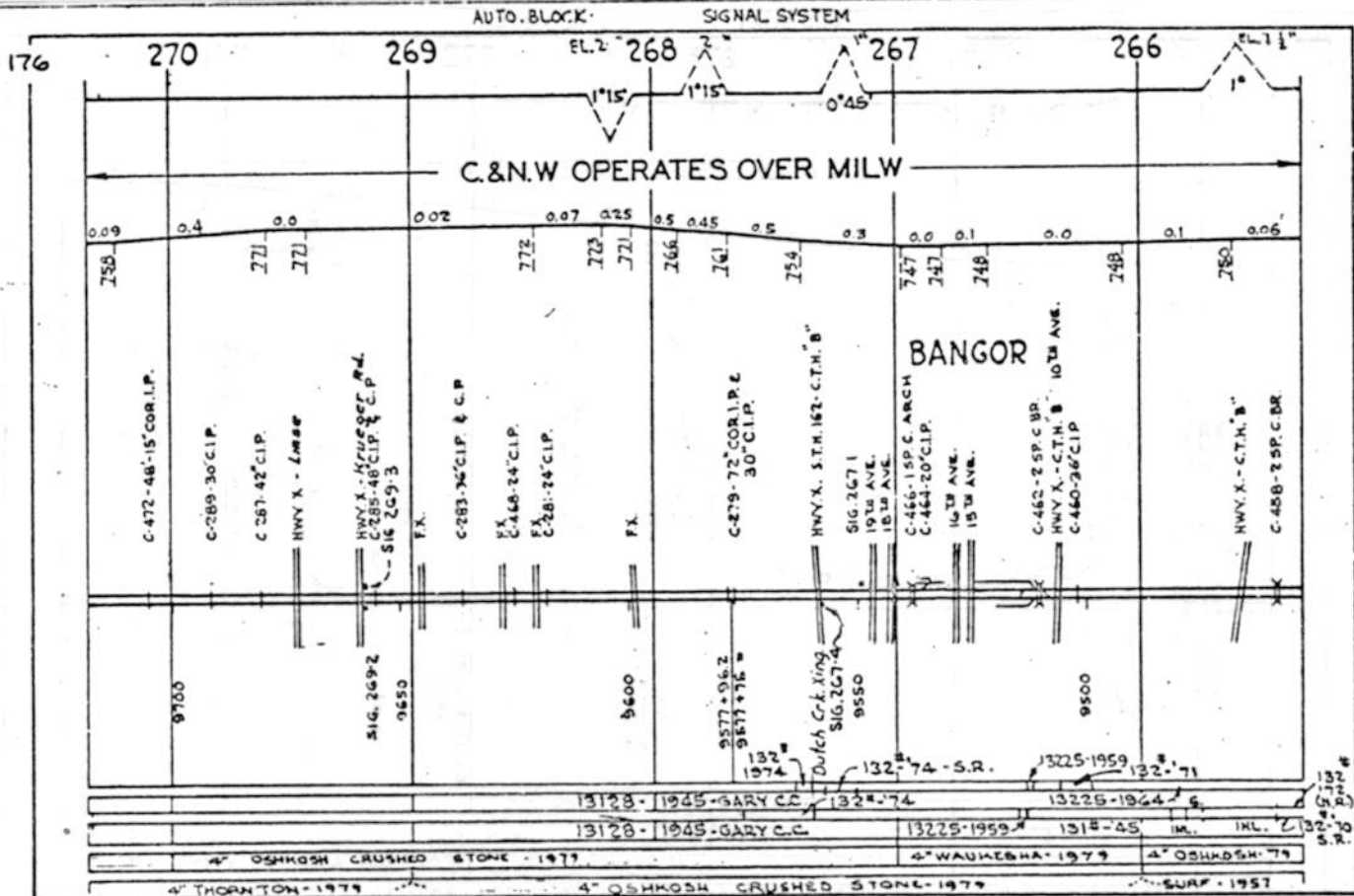

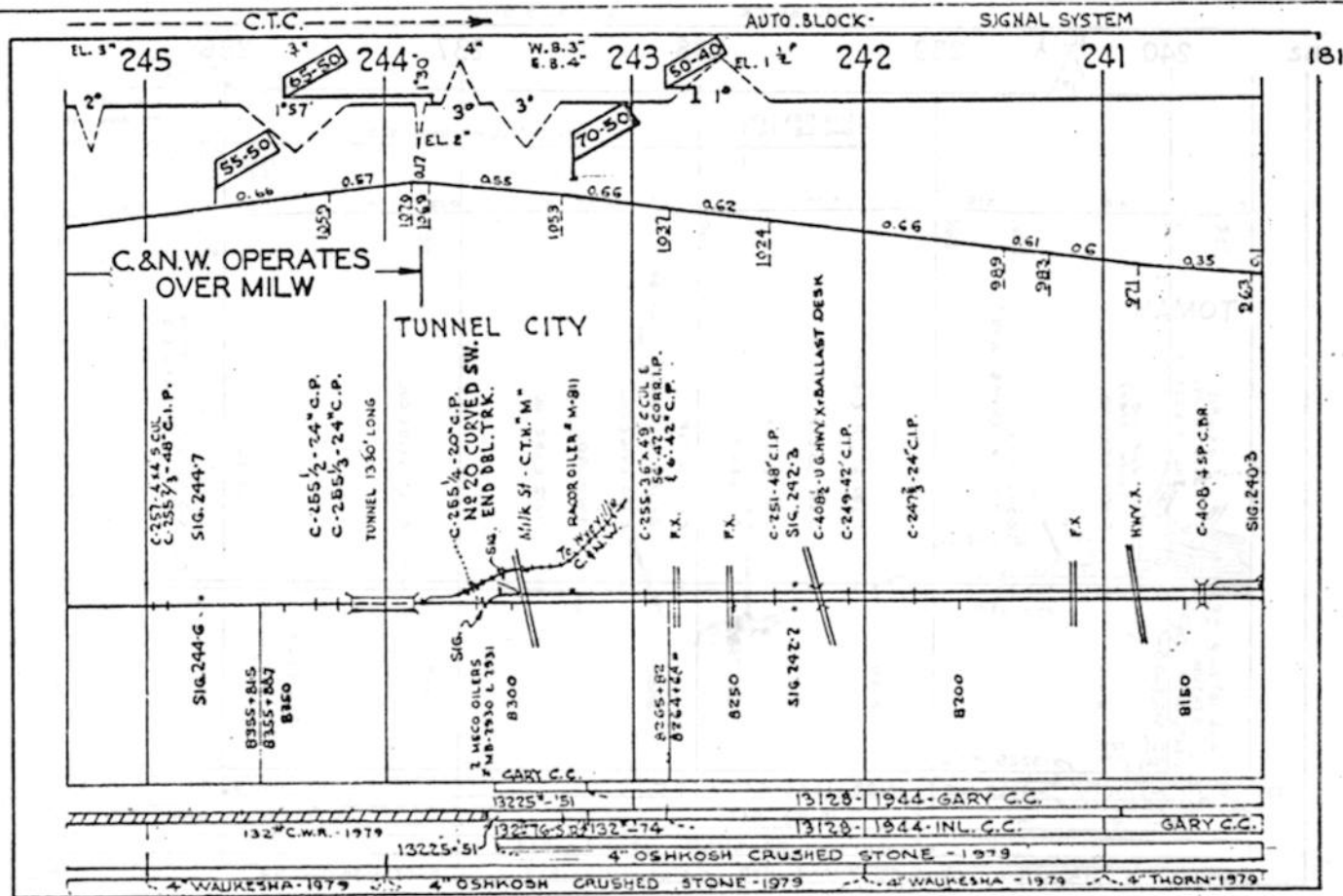
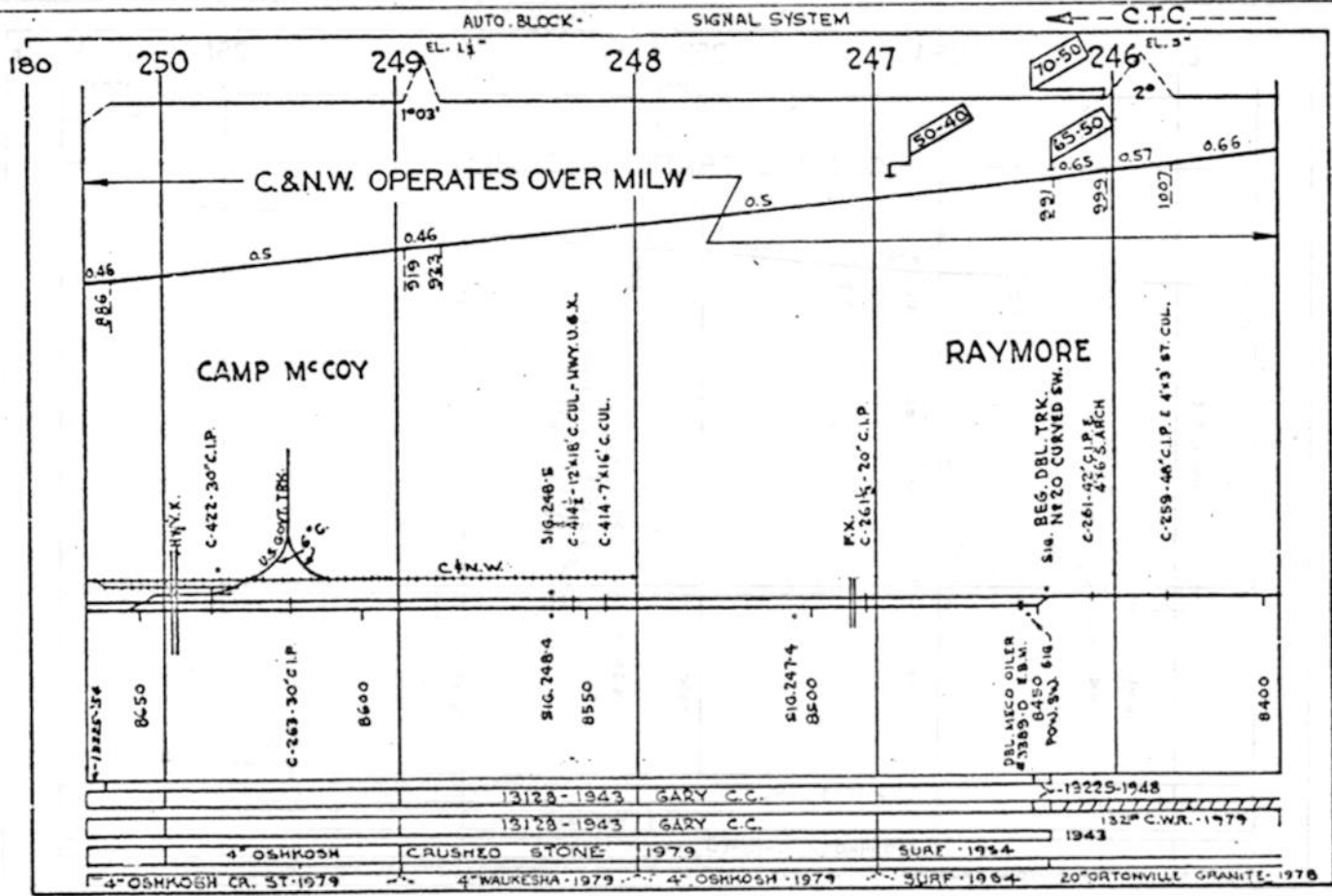

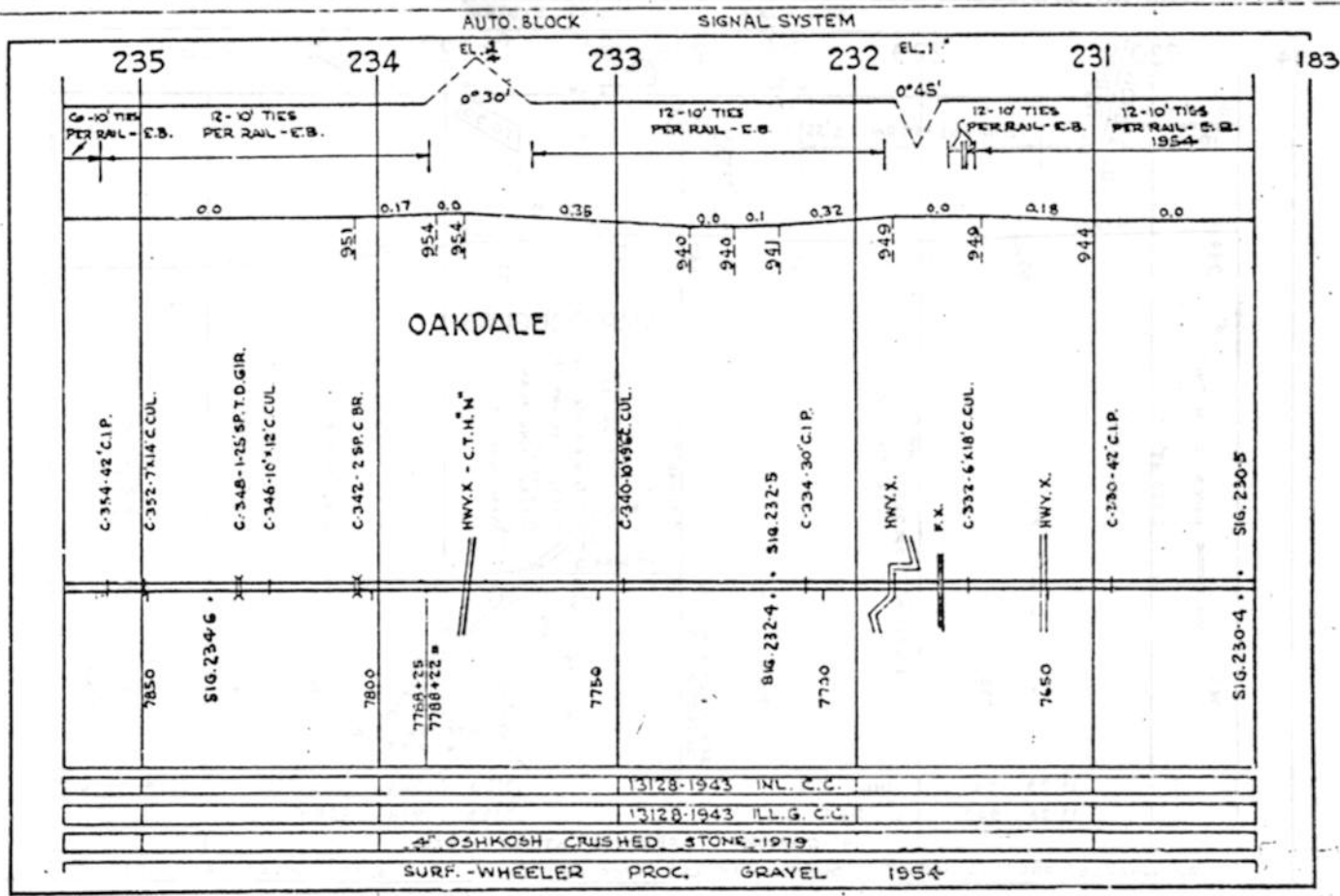
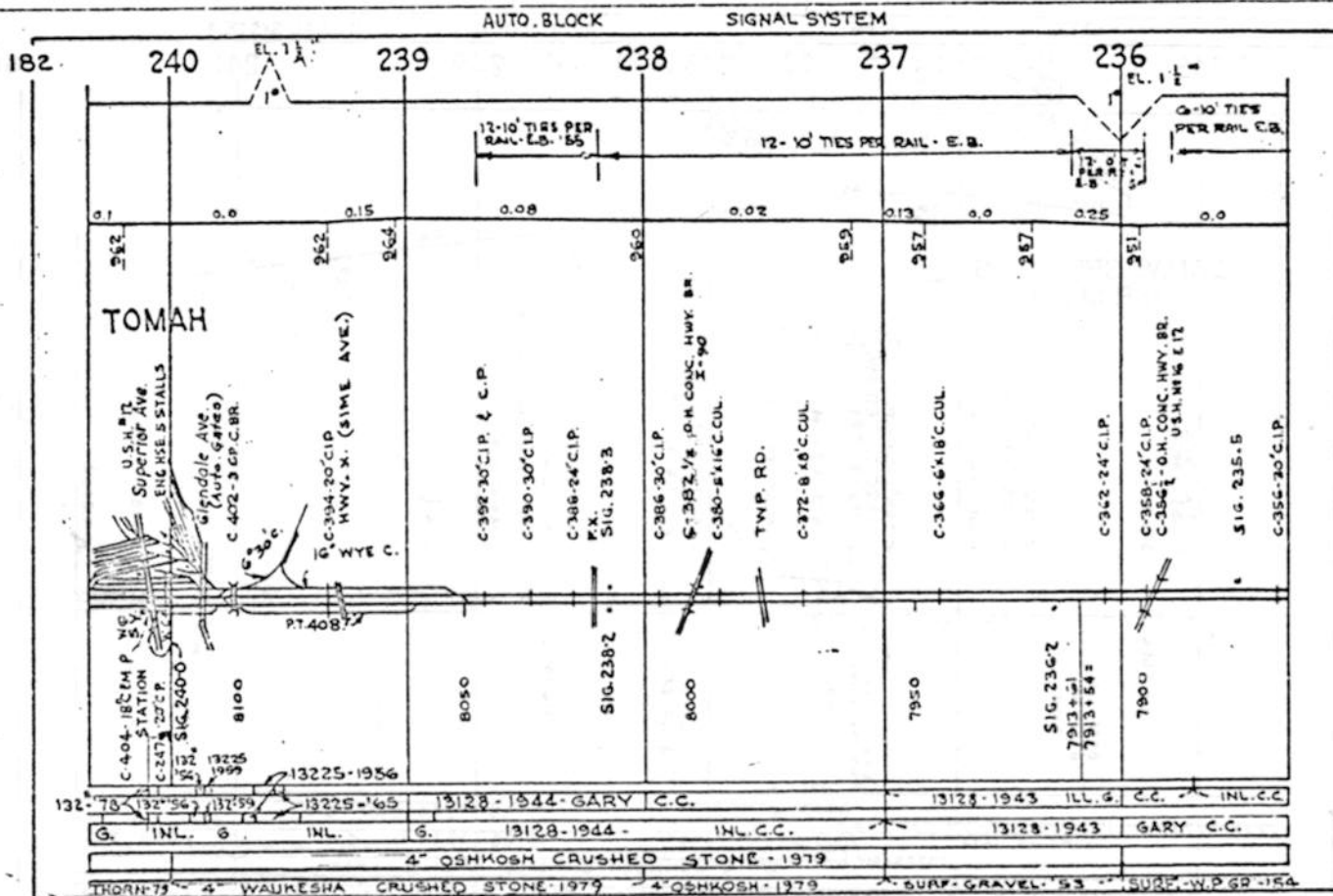

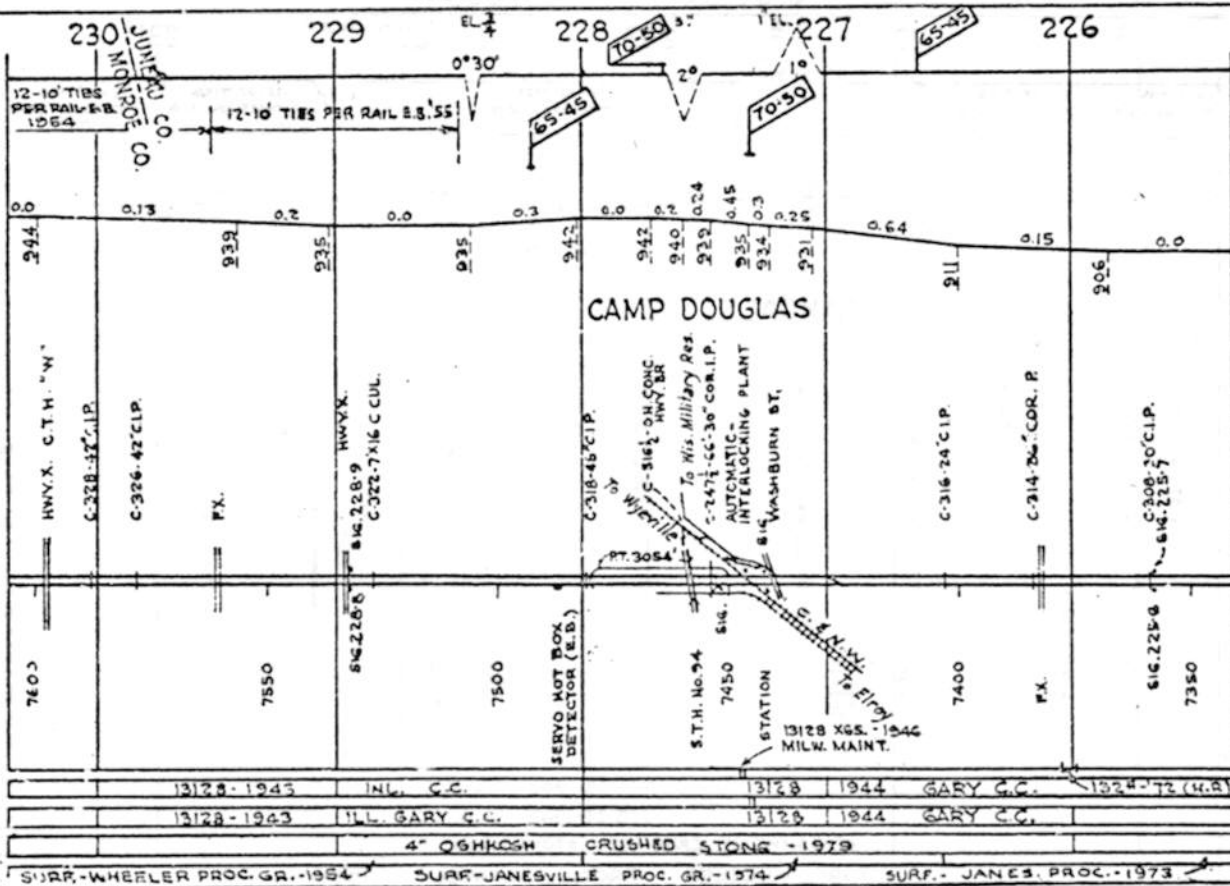

13128-1945	INL. C.C.	13128	1944	GARY C.C.	1324-73 (W.B.)
13128-1943	ILL. GARY C.C.	13128	1944	GARY C.C.	
4" OSHKOSH CRUSHED STONE - 1979					
SURF. WHEELER PROC. GR. - 1954		SURF. JAMESVILLE PROC. GR. - 1974		SURF. JAMES. PROC. - 1973	

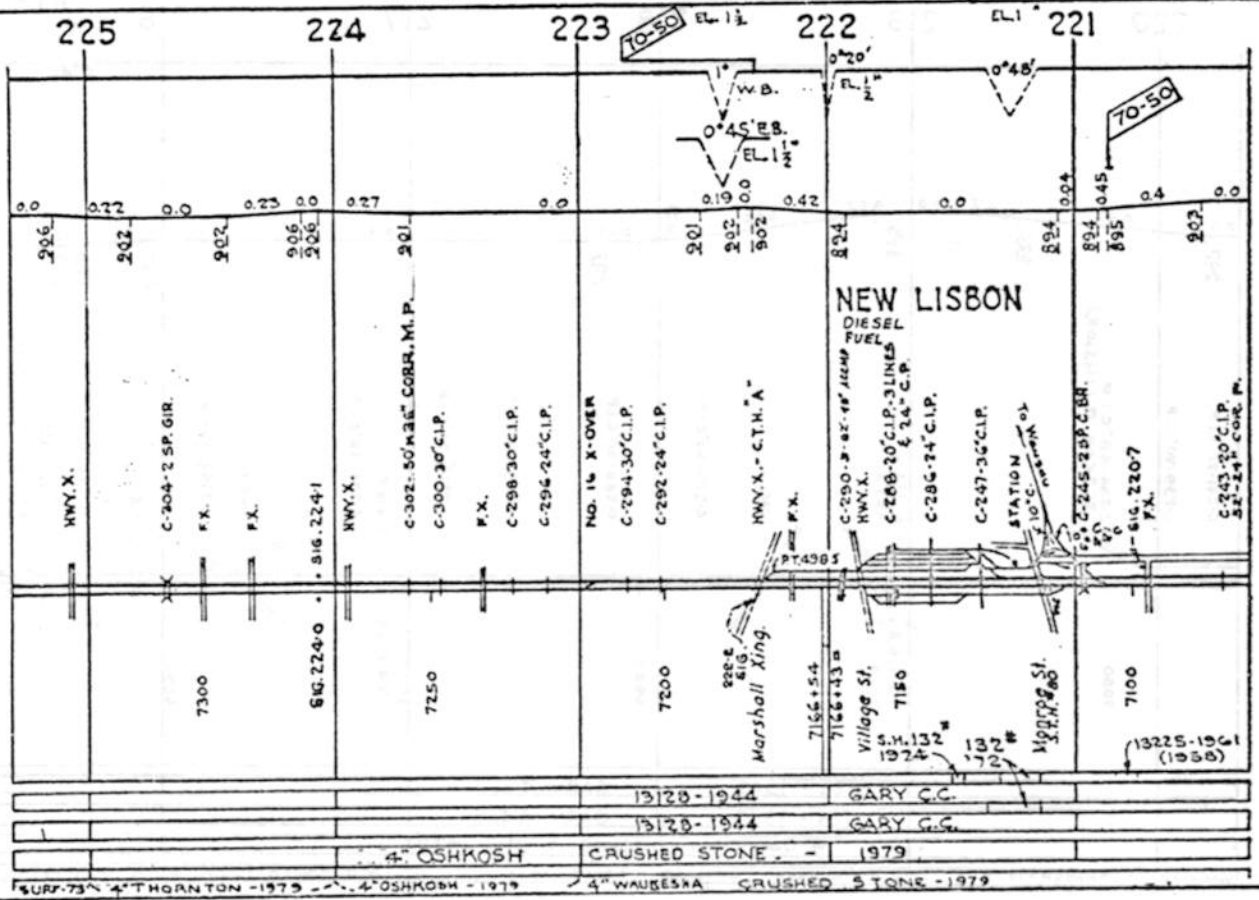

13128-1944	GARY C.C.	13128-1944	GARY C.C.
4" OSHKOSH CRUSHED STONE - 1979			
SURF. 73" 4" THORNTON - 1979		4" WAUBESA CRUSHED STONE - 1979	

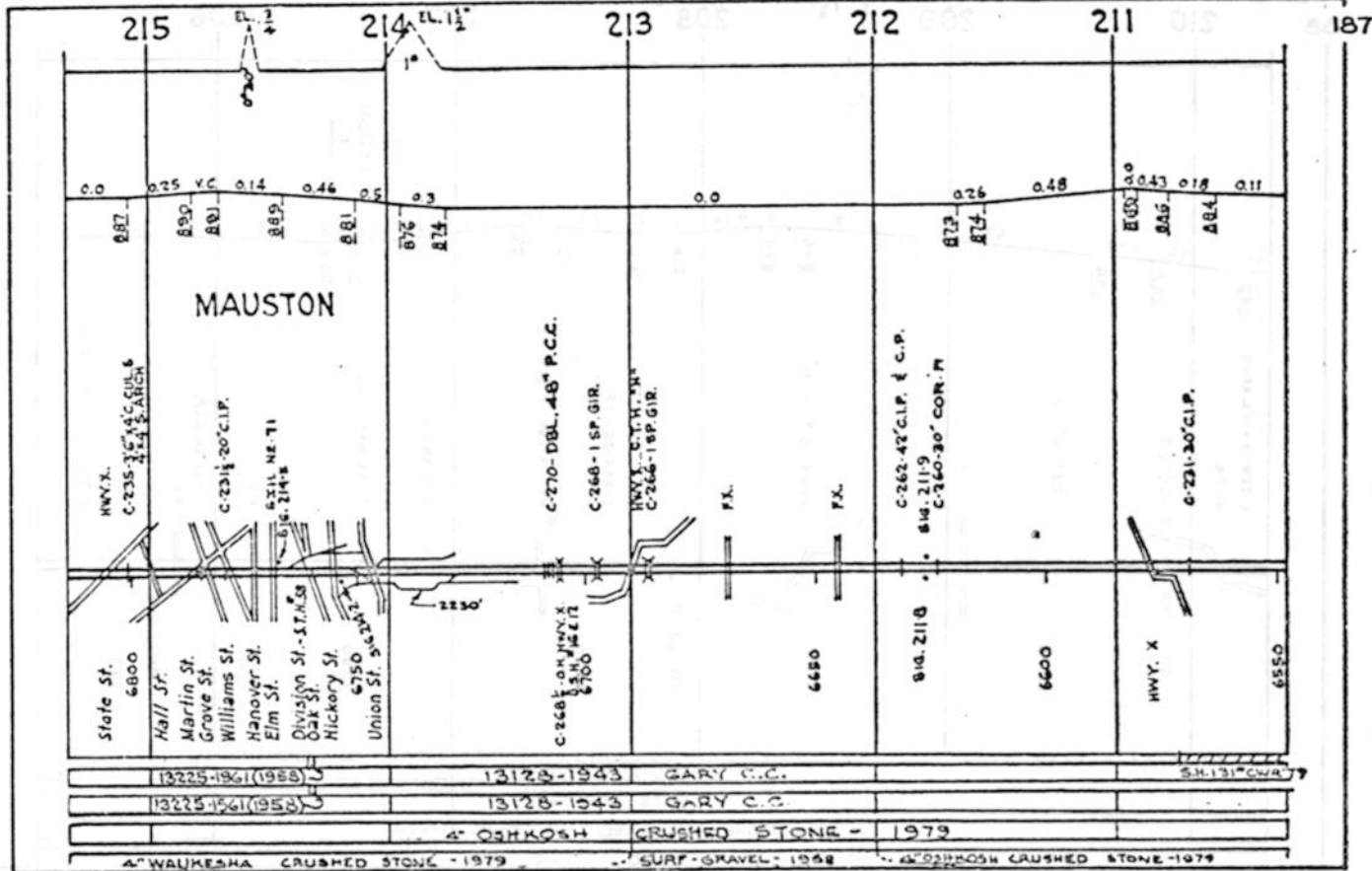
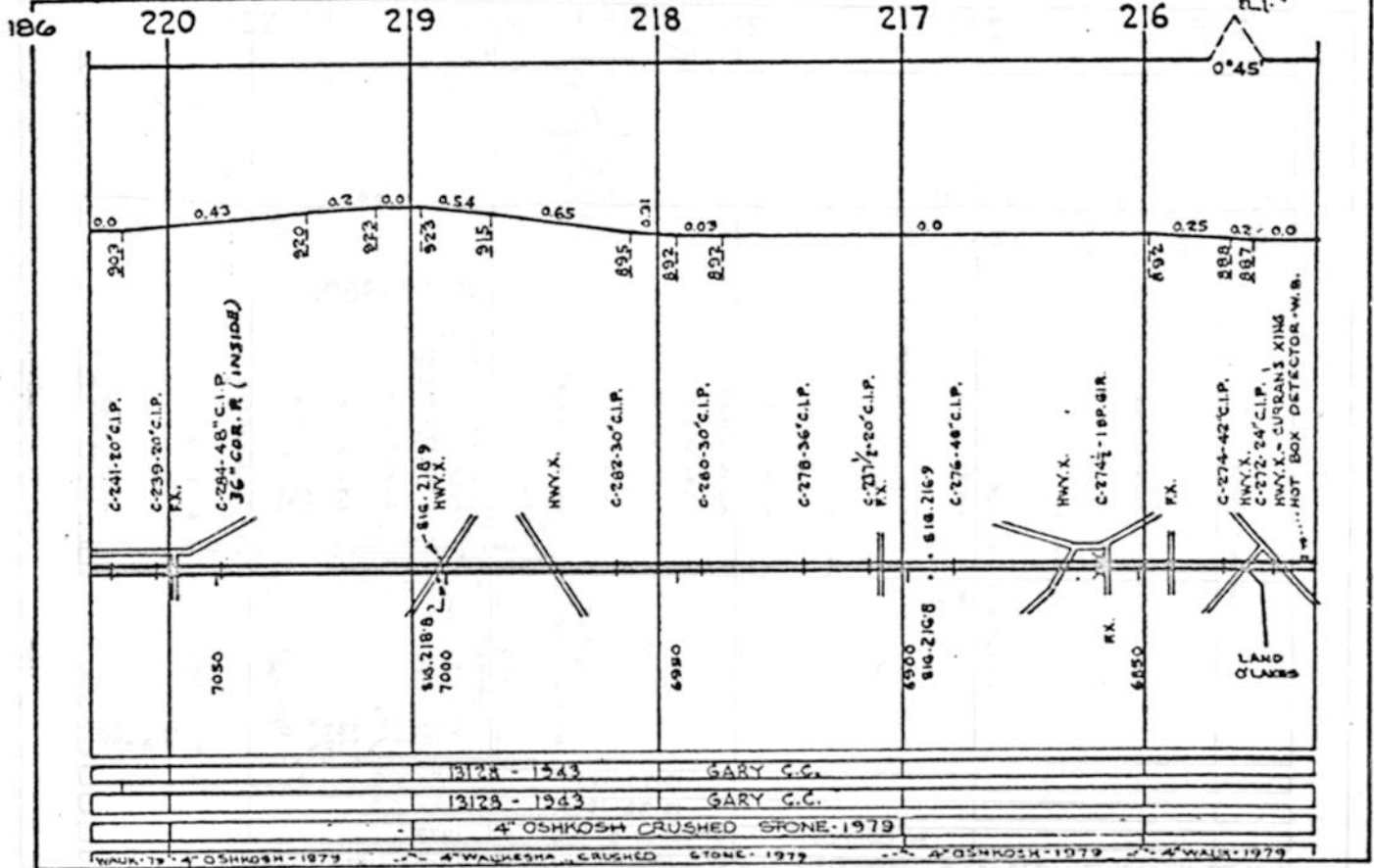

AUTO. BLOCK- SYSTEM

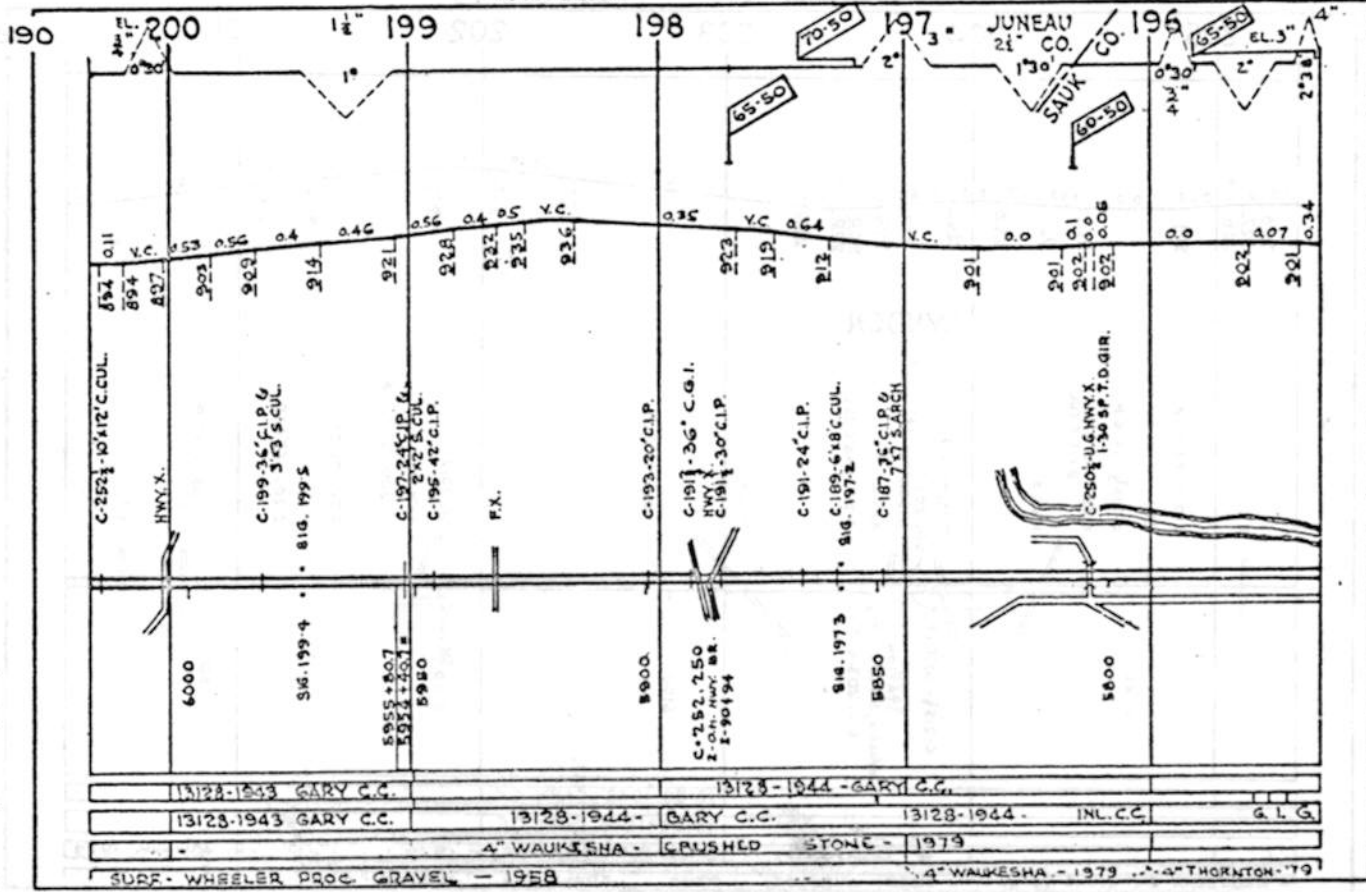

AUTO. BLOCK SIGNAL SYSTEM

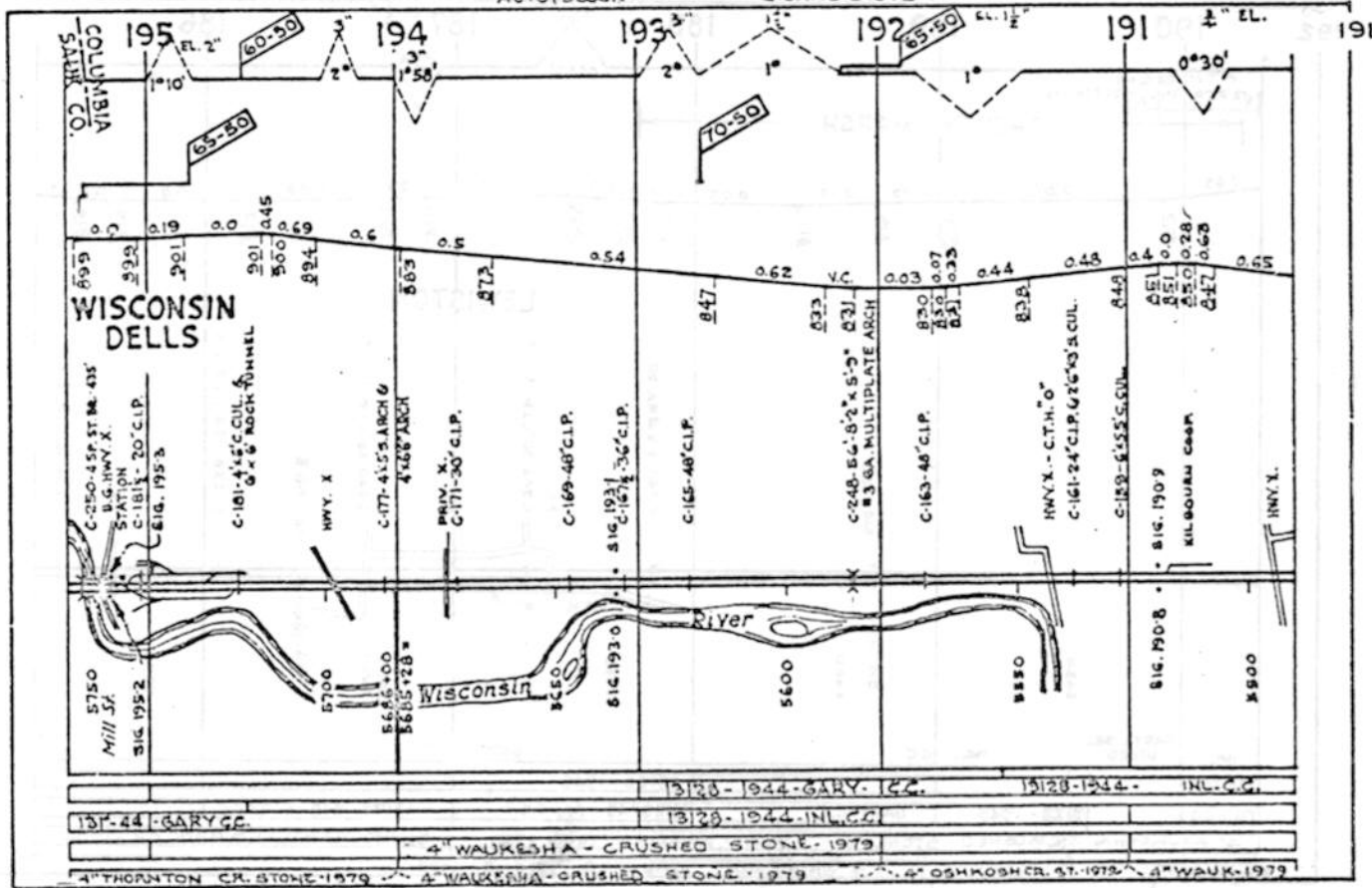

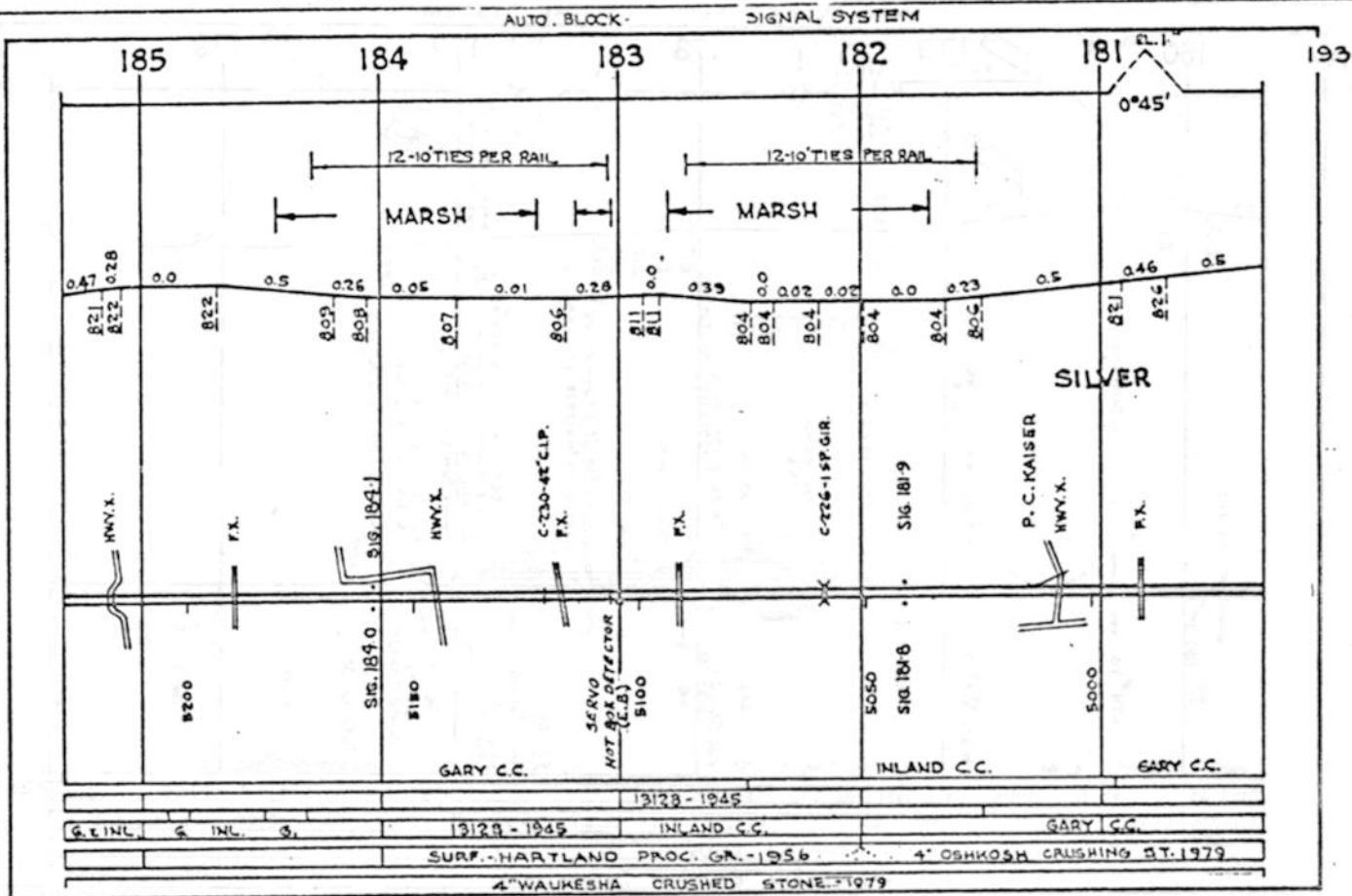
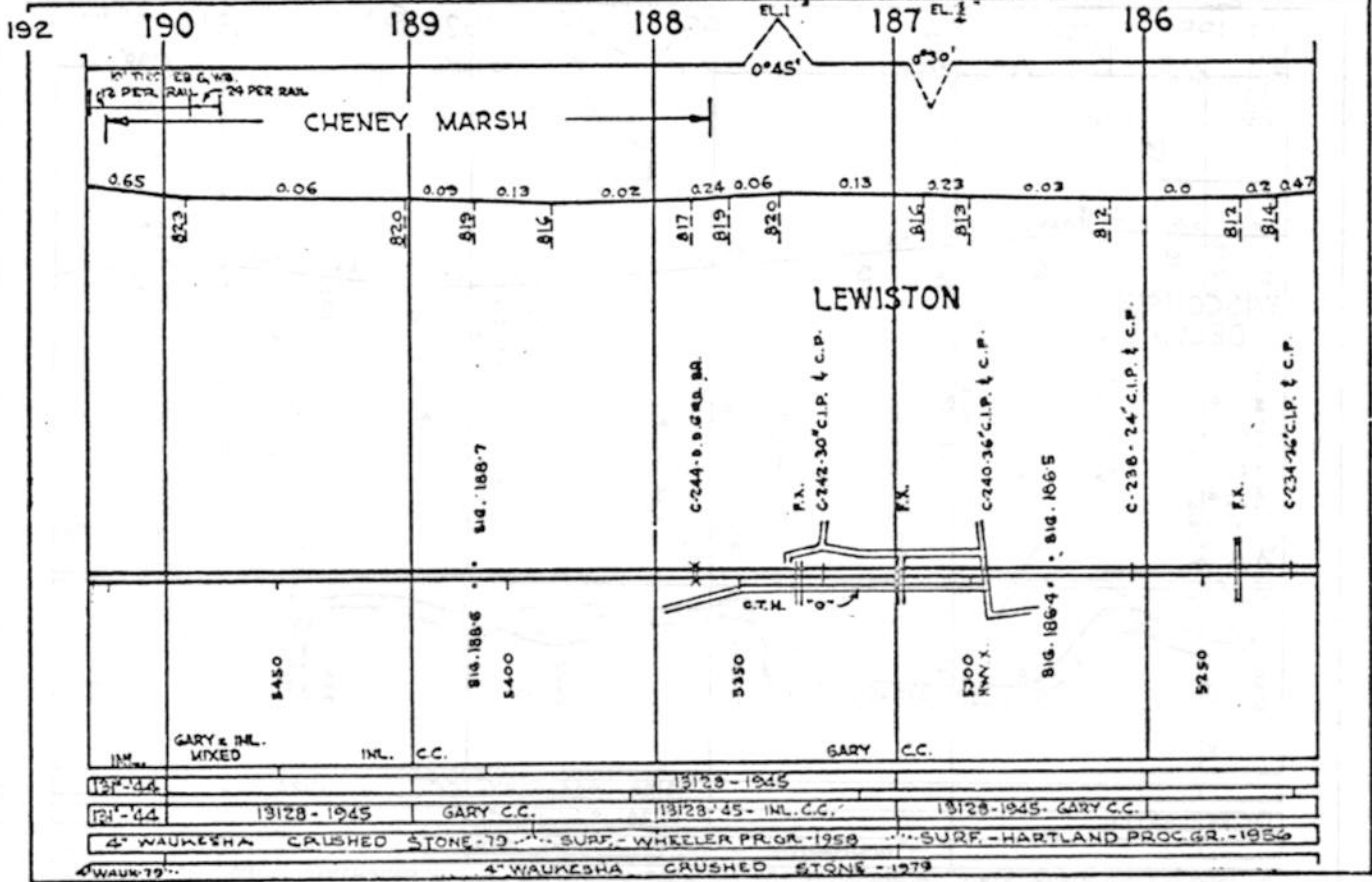

AUTOMATIC BLOCK SYSTEM

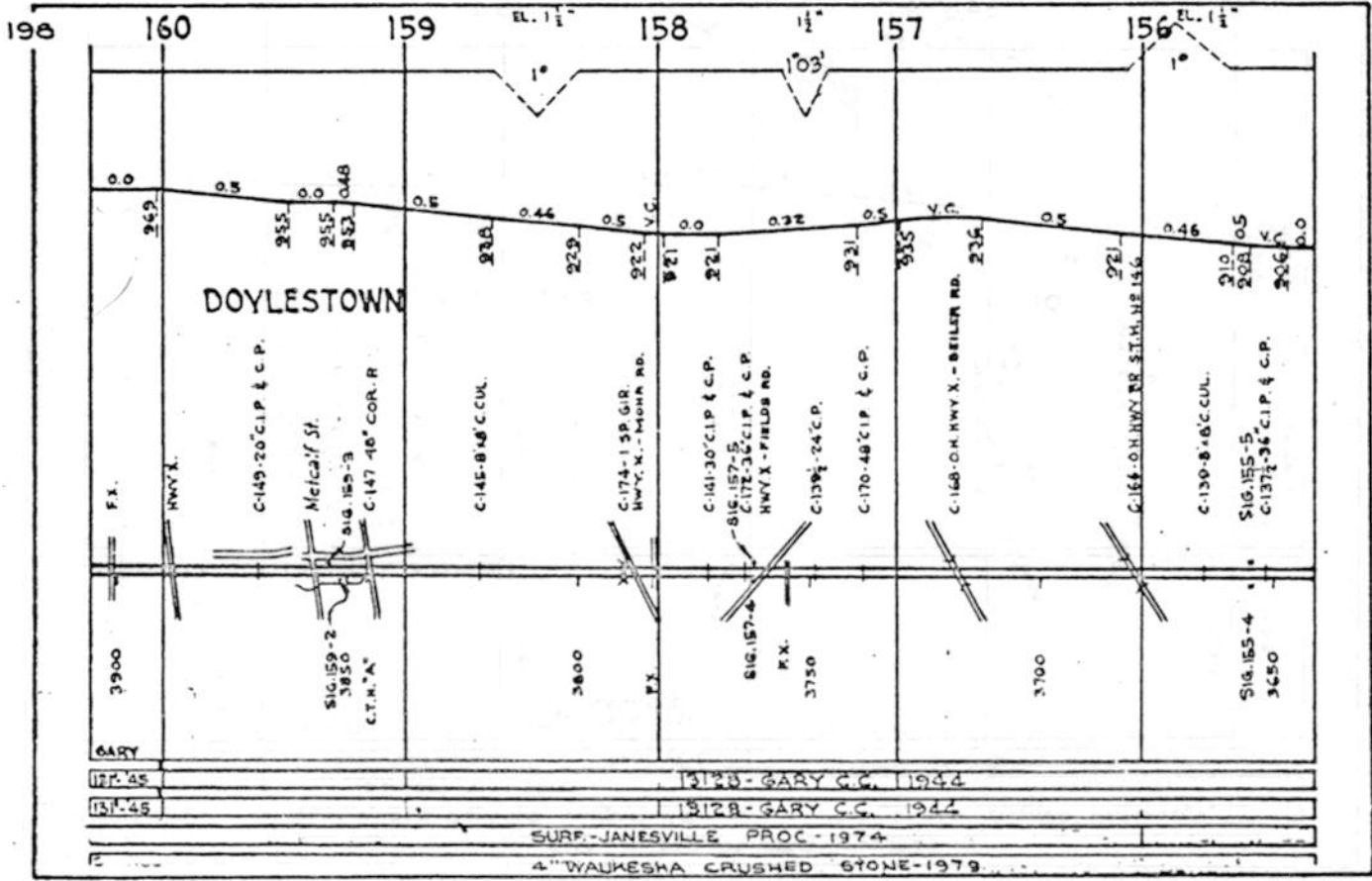

AUTOMATIC BLOCK SYSTEM

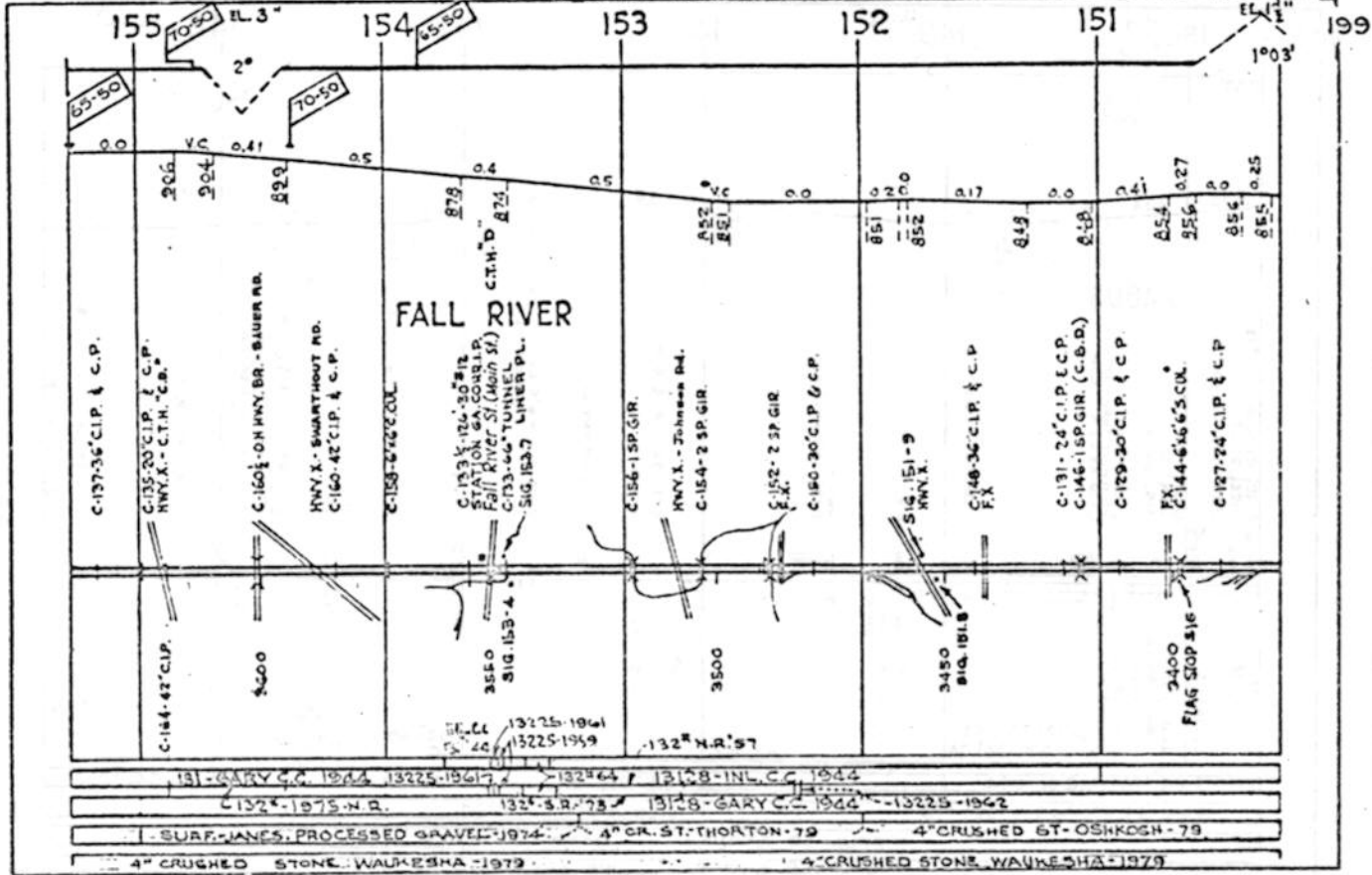

- AUTOMATIC BLOCK SYSTEM

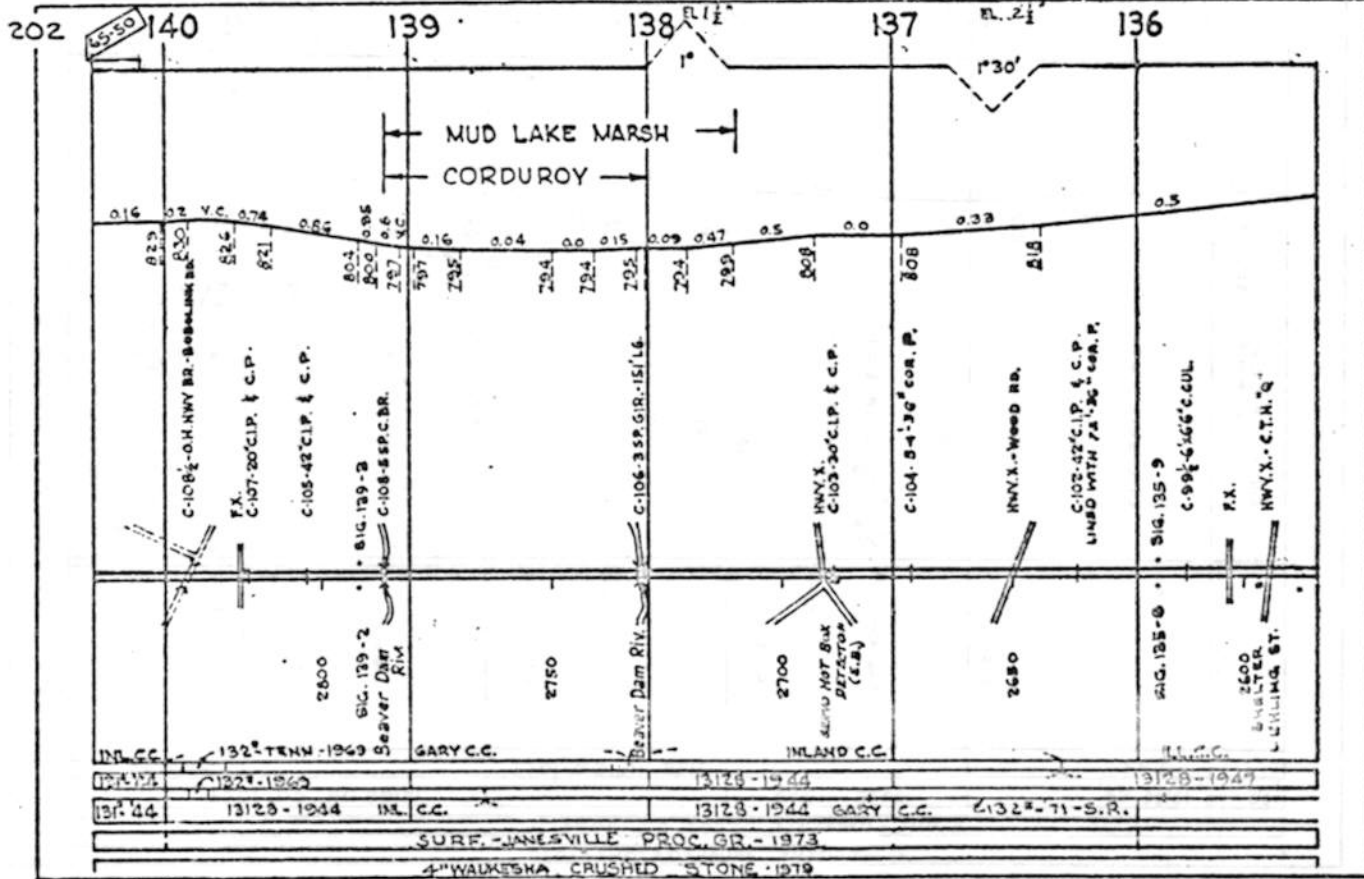

- AUTOMATIC BLOCK SYSTEM

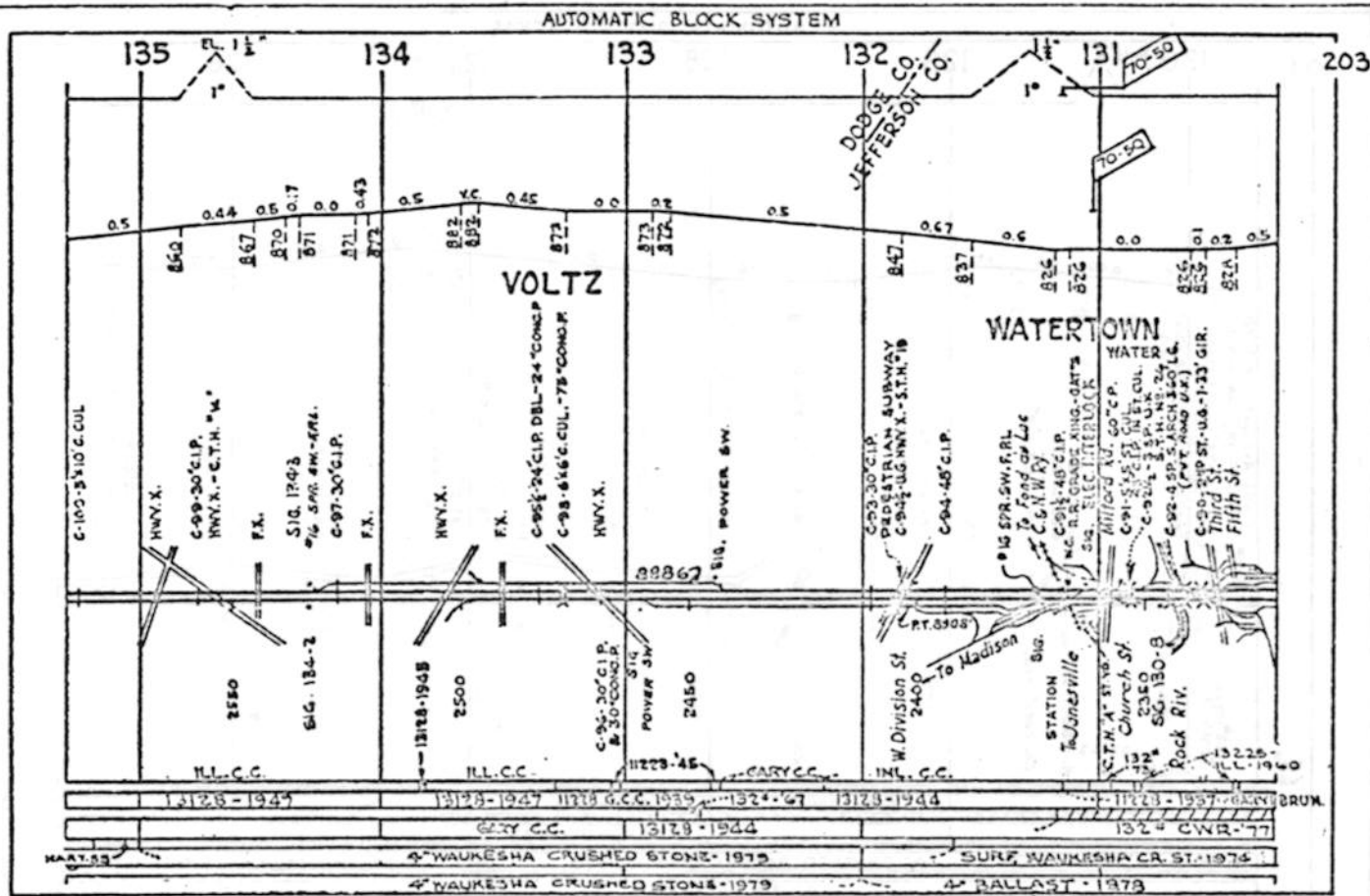

- AUTOMATIC BLOCK SYSTEM

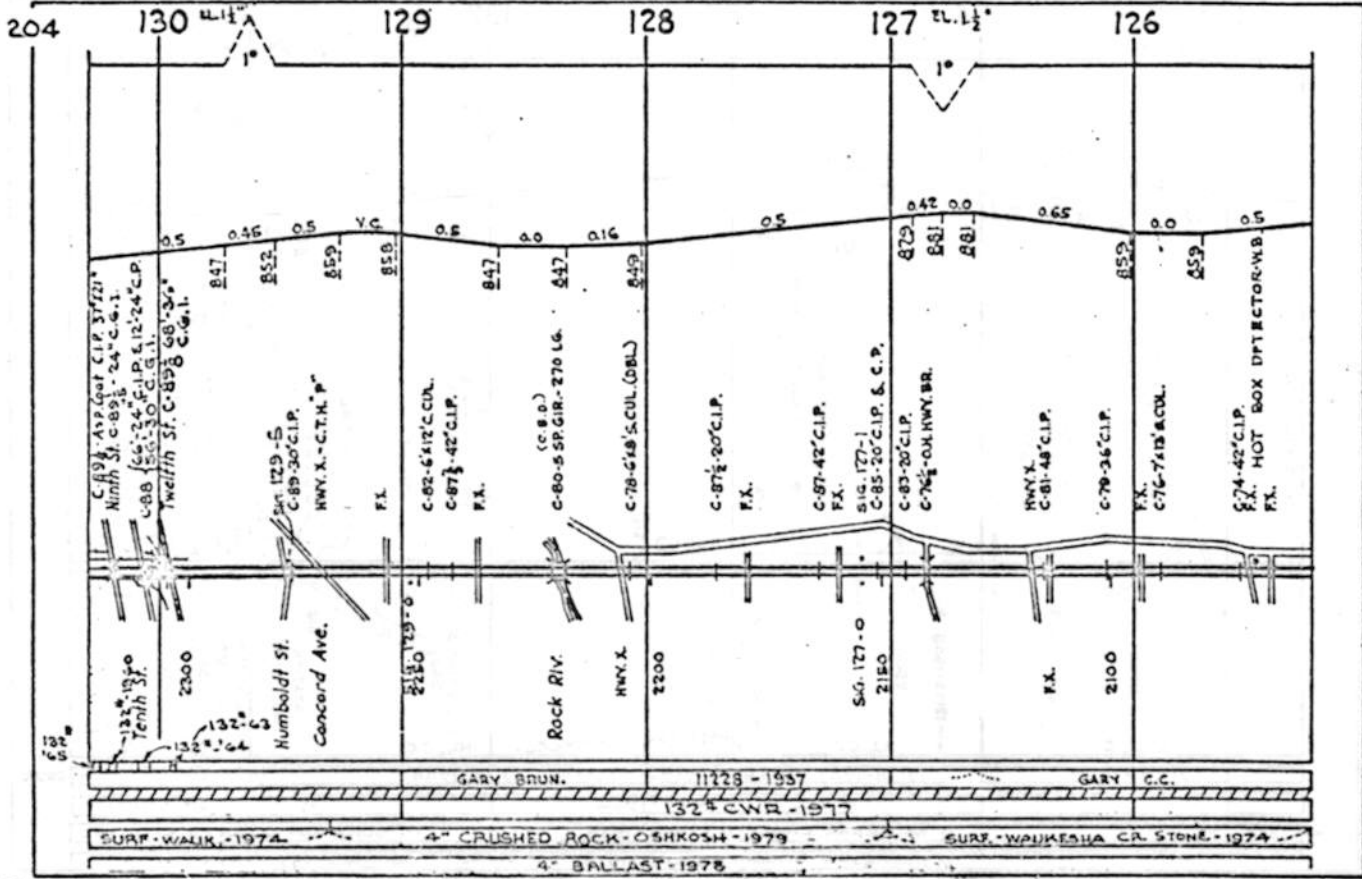

AUTOMATIC BLOCK SYSTEM

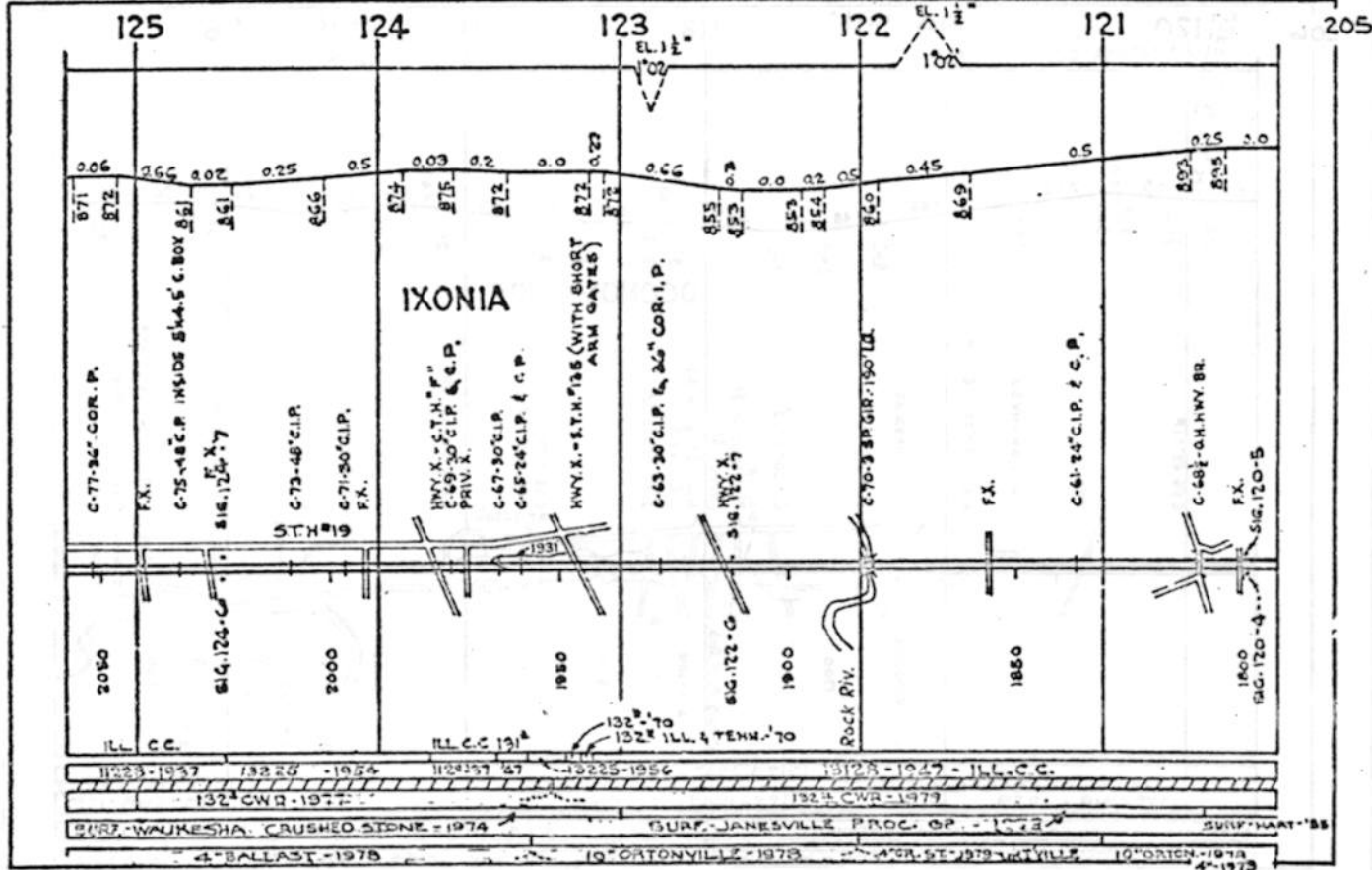

AUTOMATIC BLOCK SYSTEM

AUTOMATIC BLOCK SYSTEM

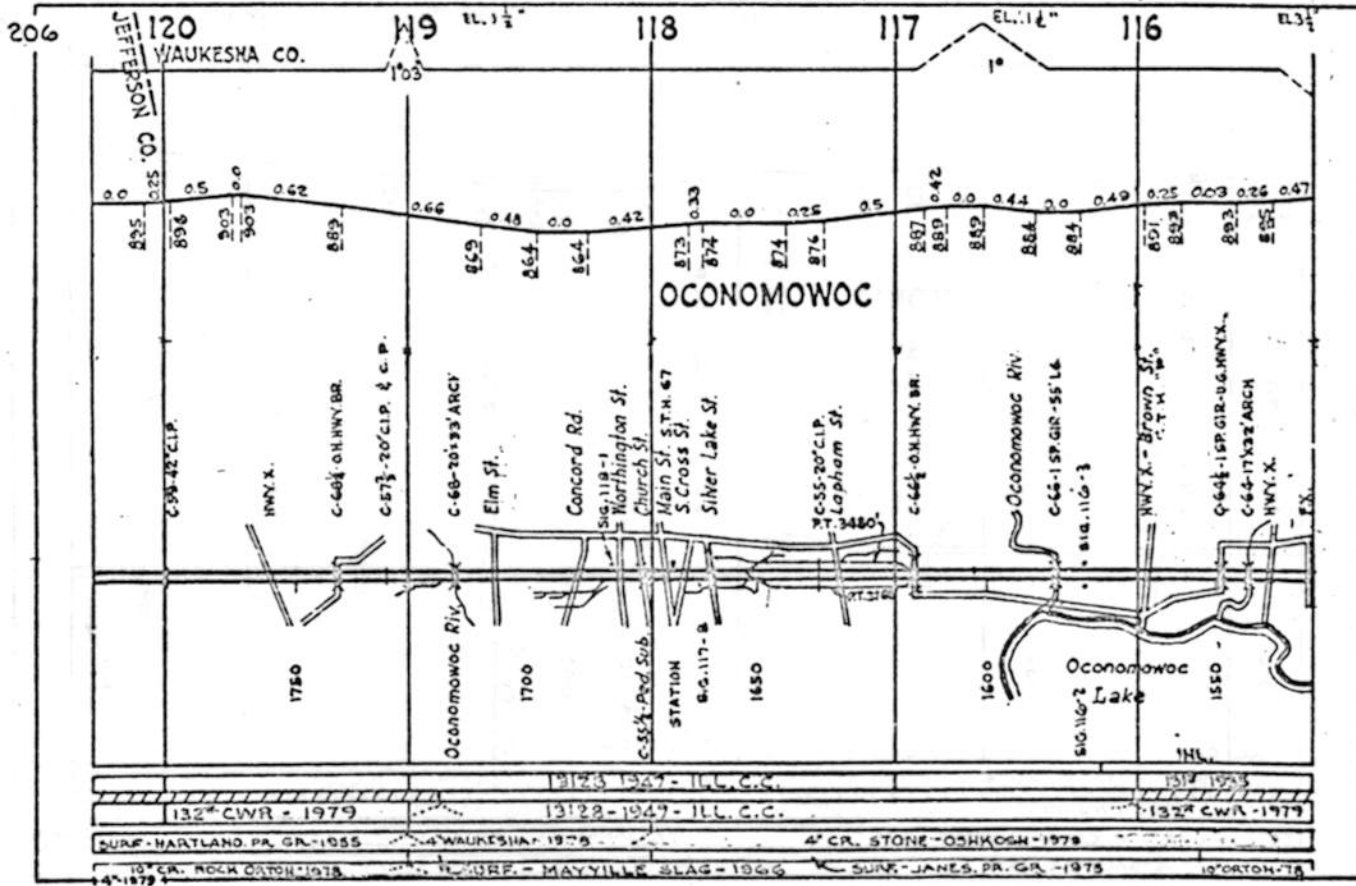

AUTOMATIC BLOCK SYSTEM

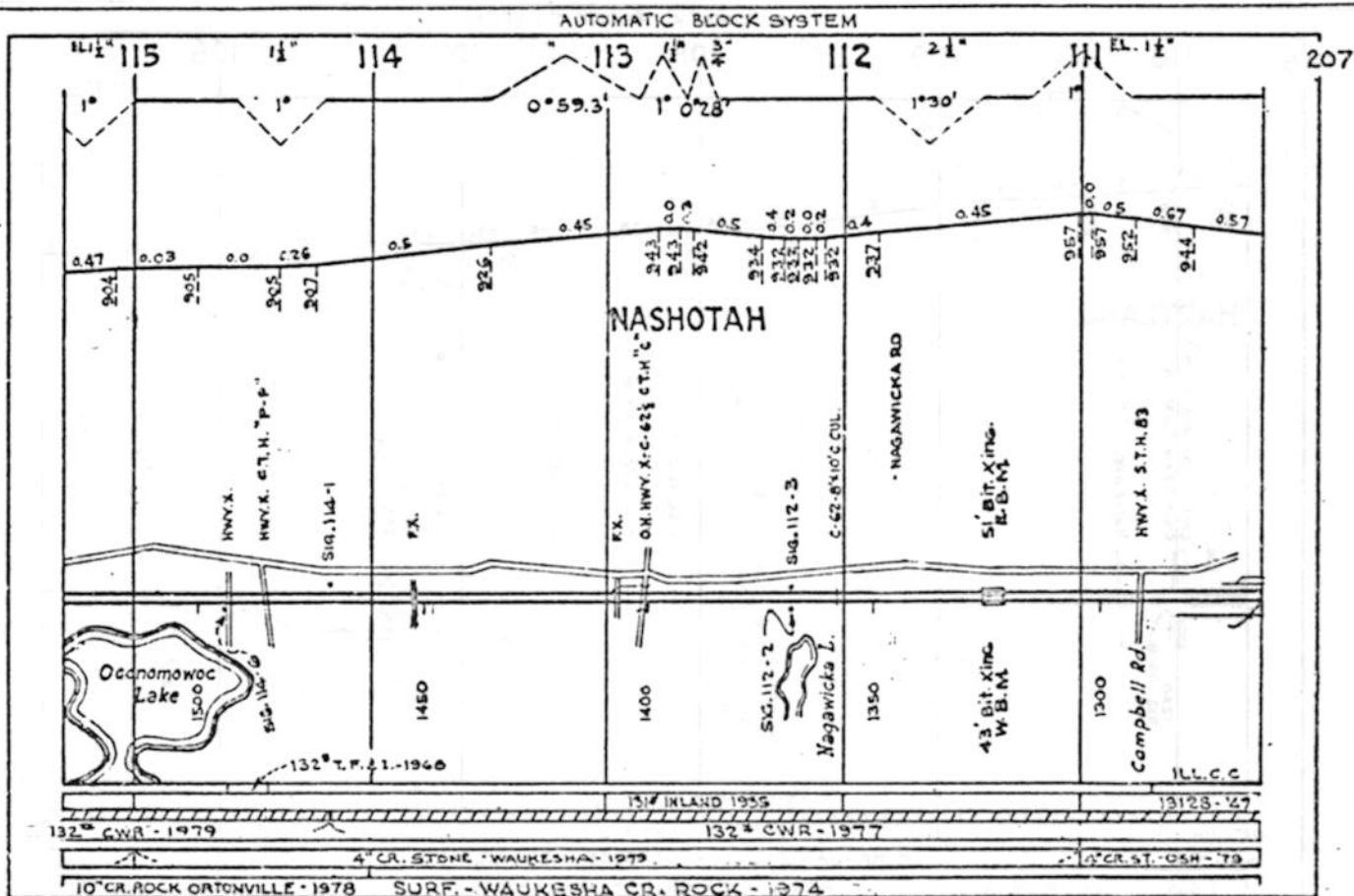

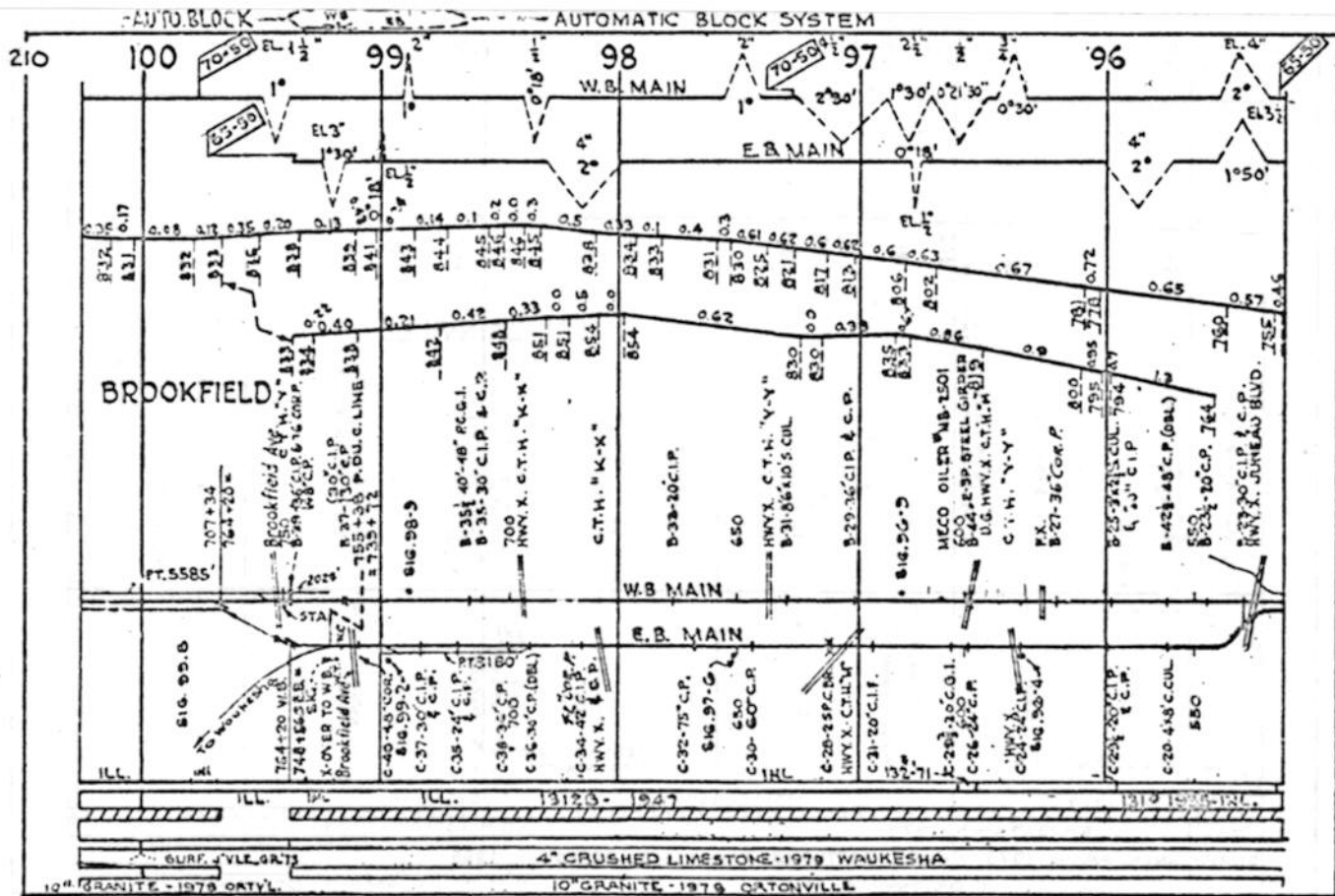

NOTE:-
WHF MAKING CORRECTIONS OF THIS
PAGE ALSO CORRECT PAGE 72 (SHEET 10)

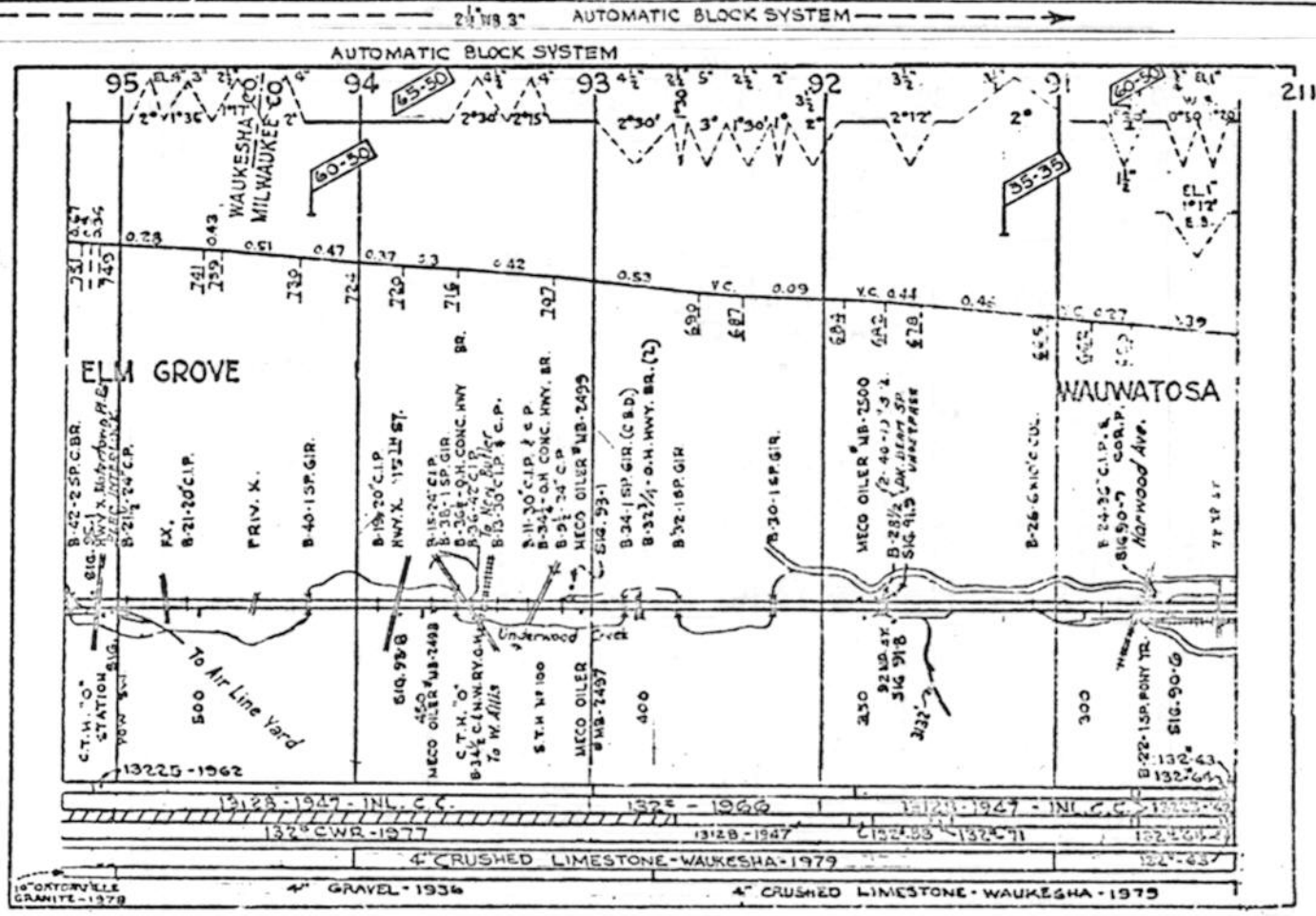

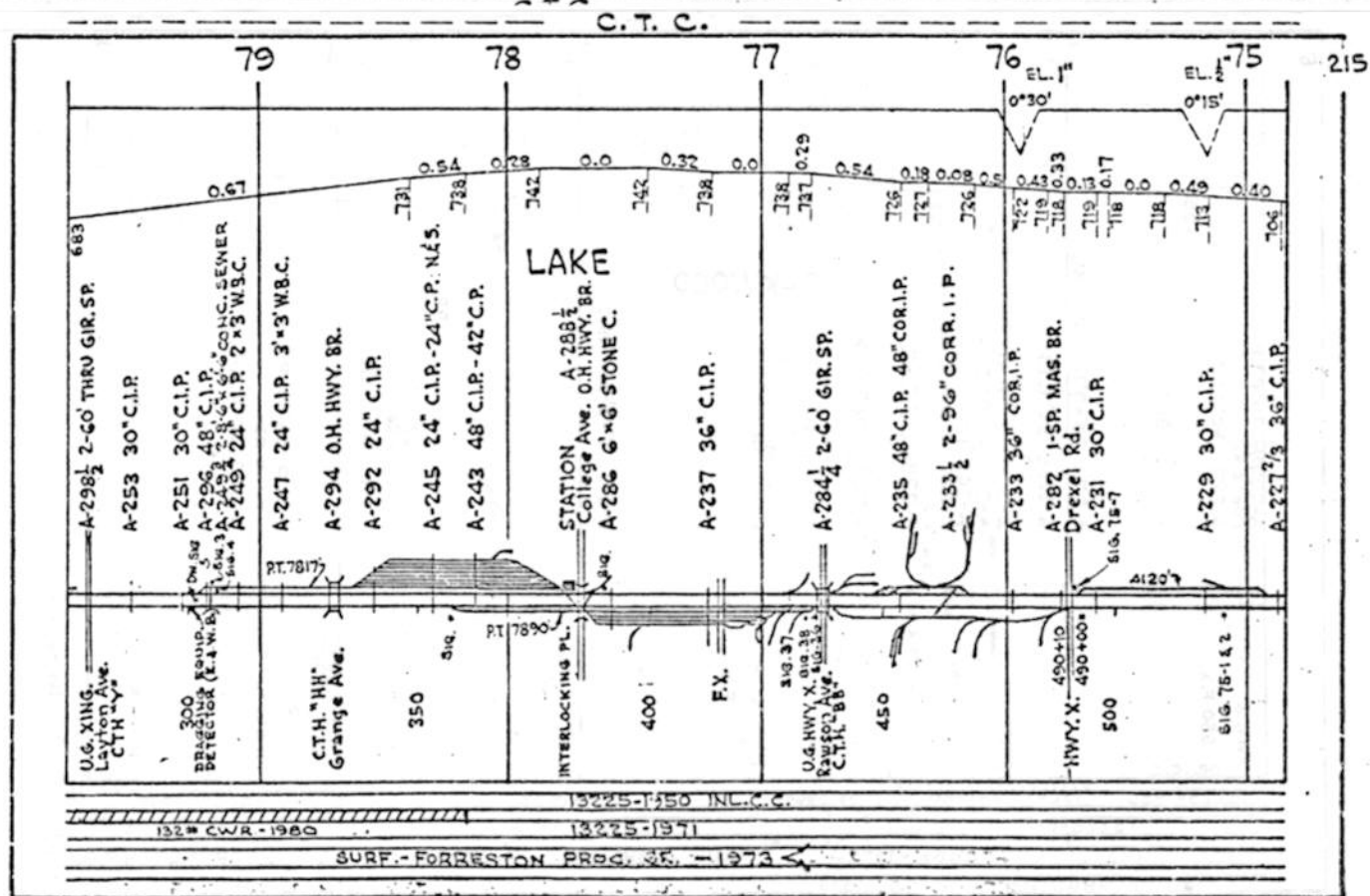
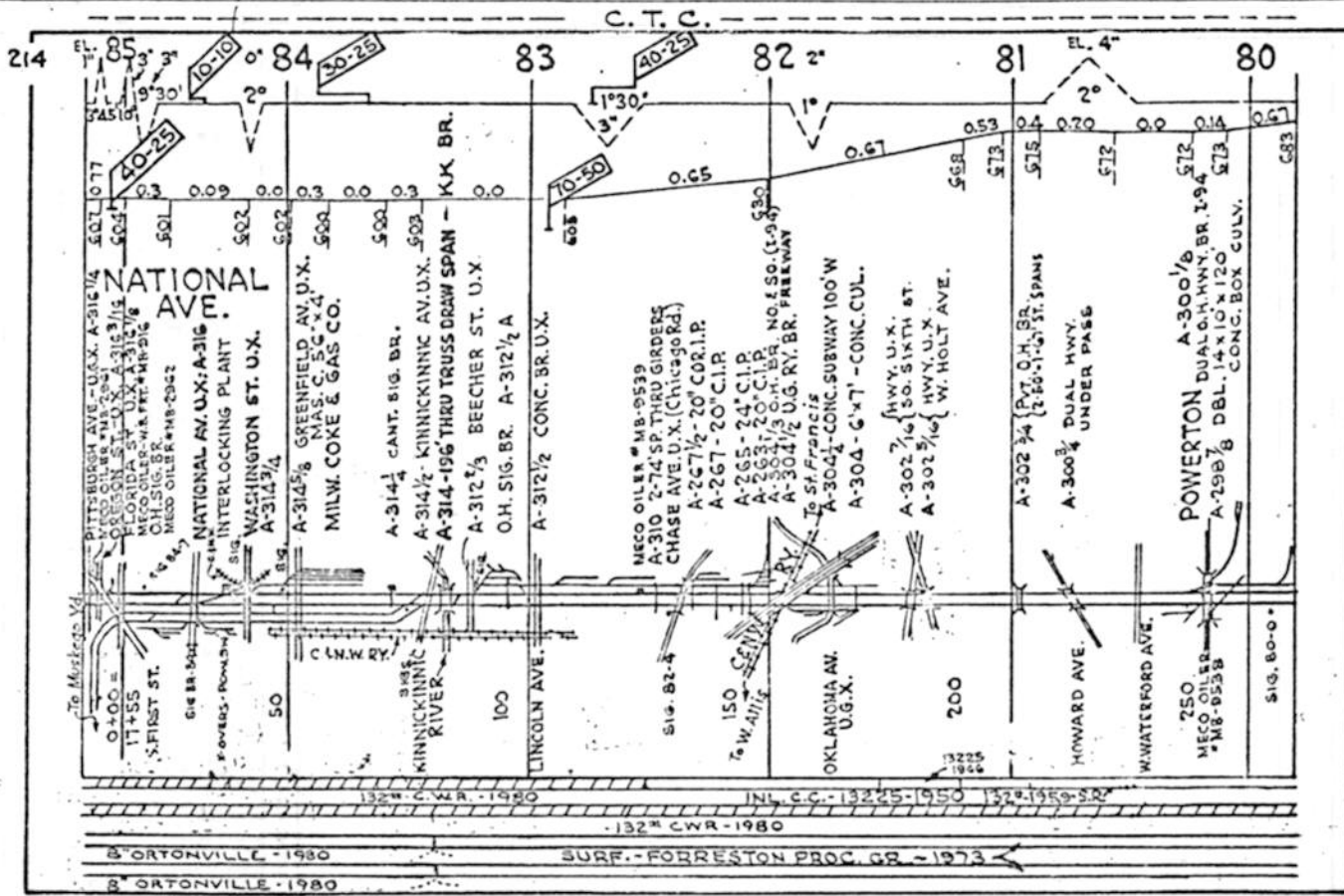

MILWAUKEE CO. RACINE CO.

OAKWOOD

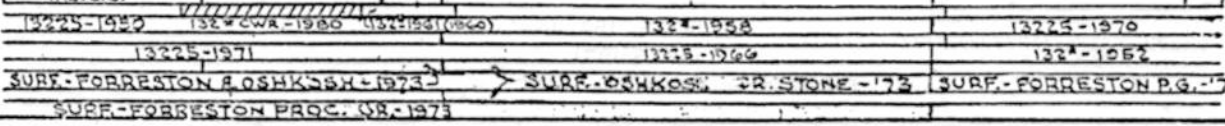
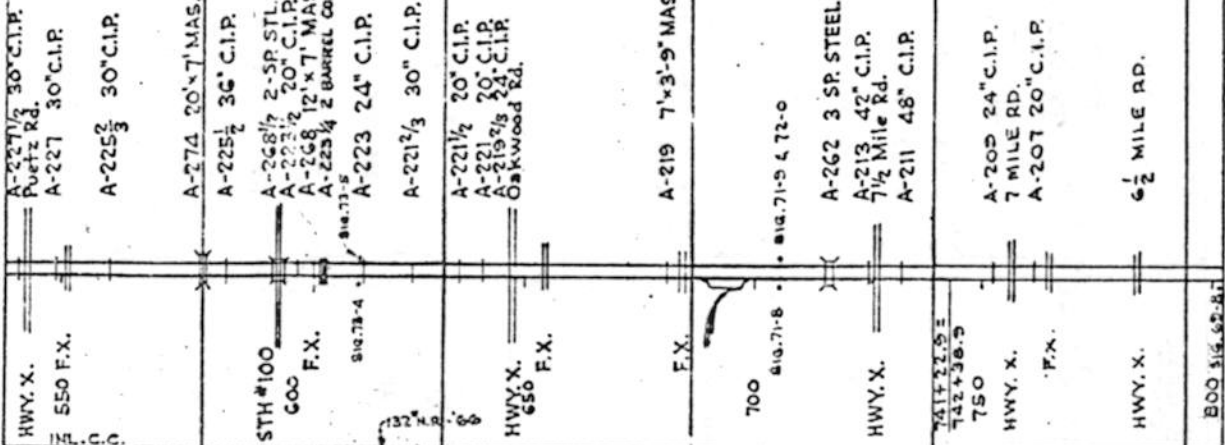

CALEDONIA

FRANKSVILLE

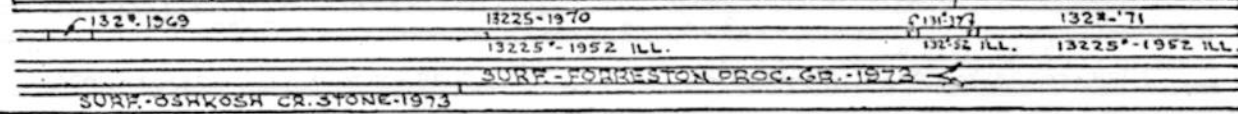
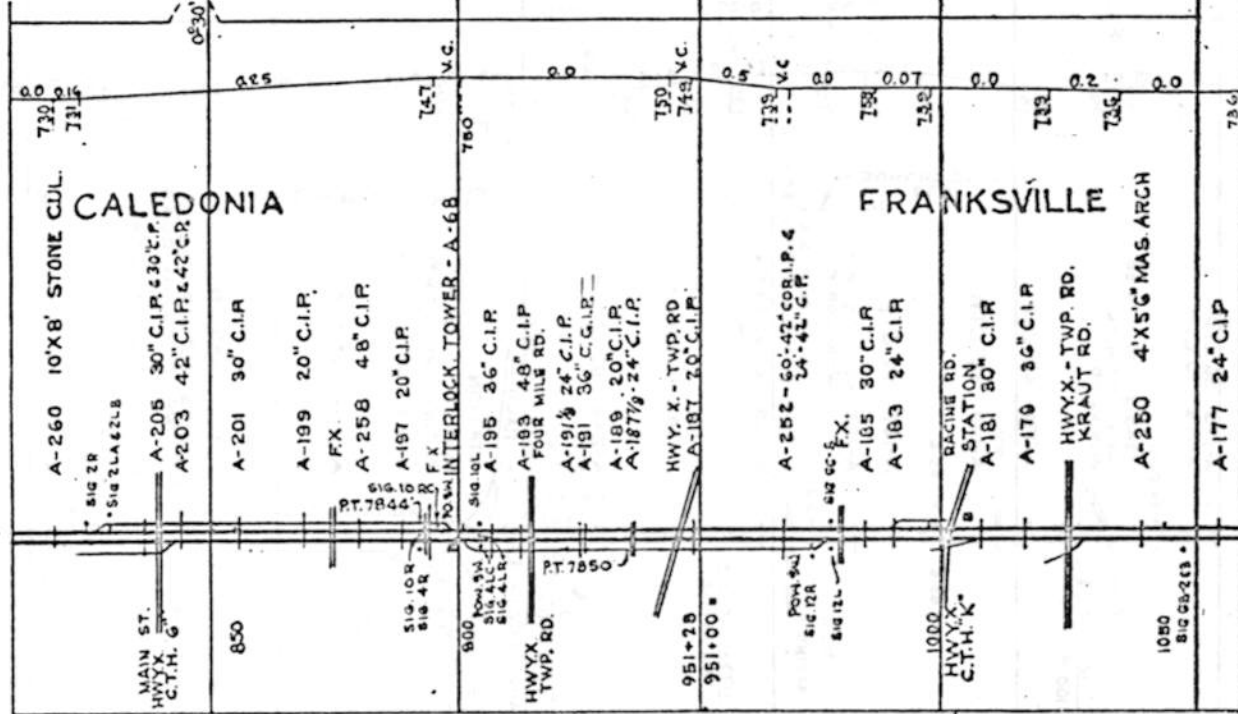

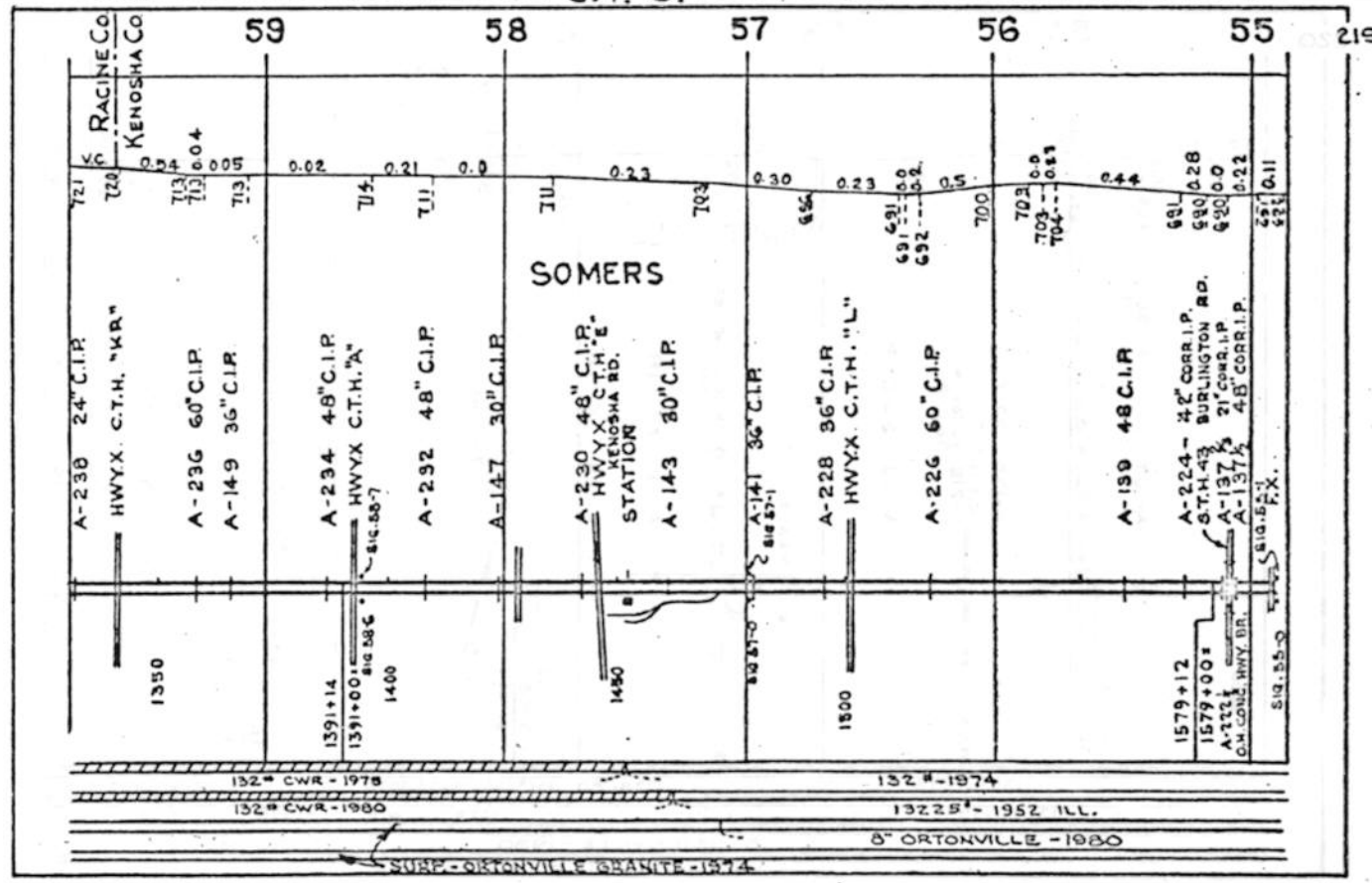
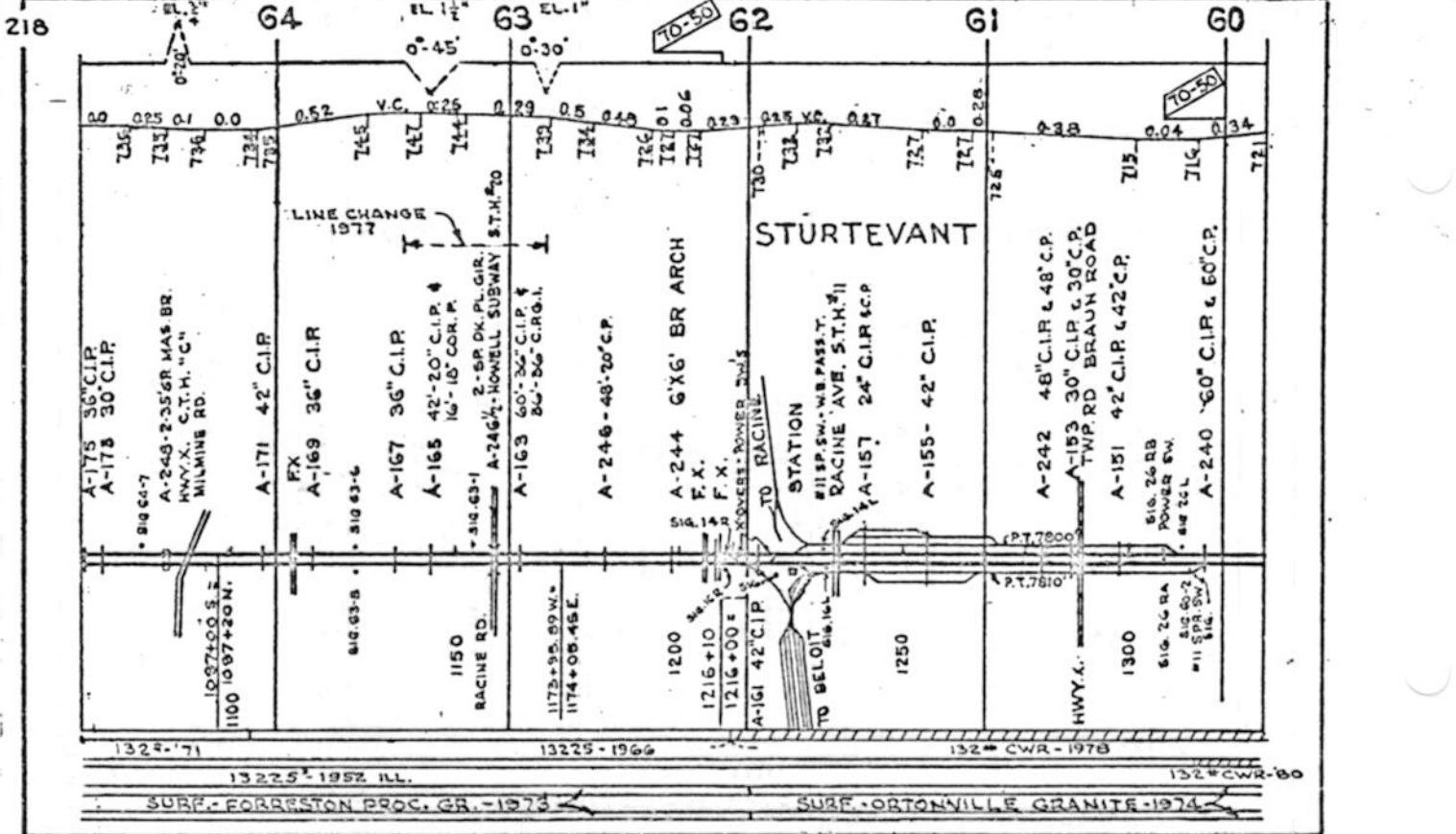

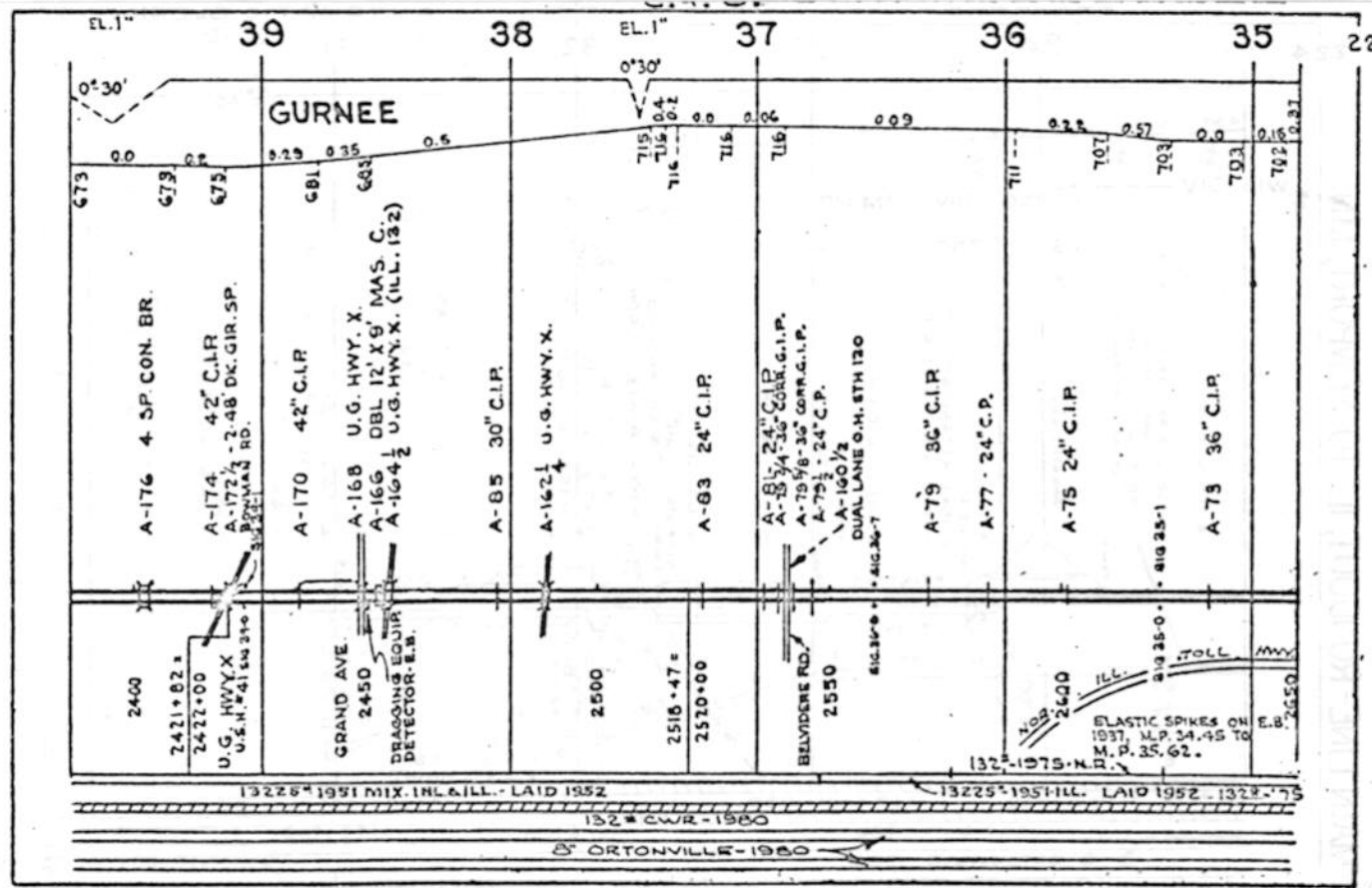
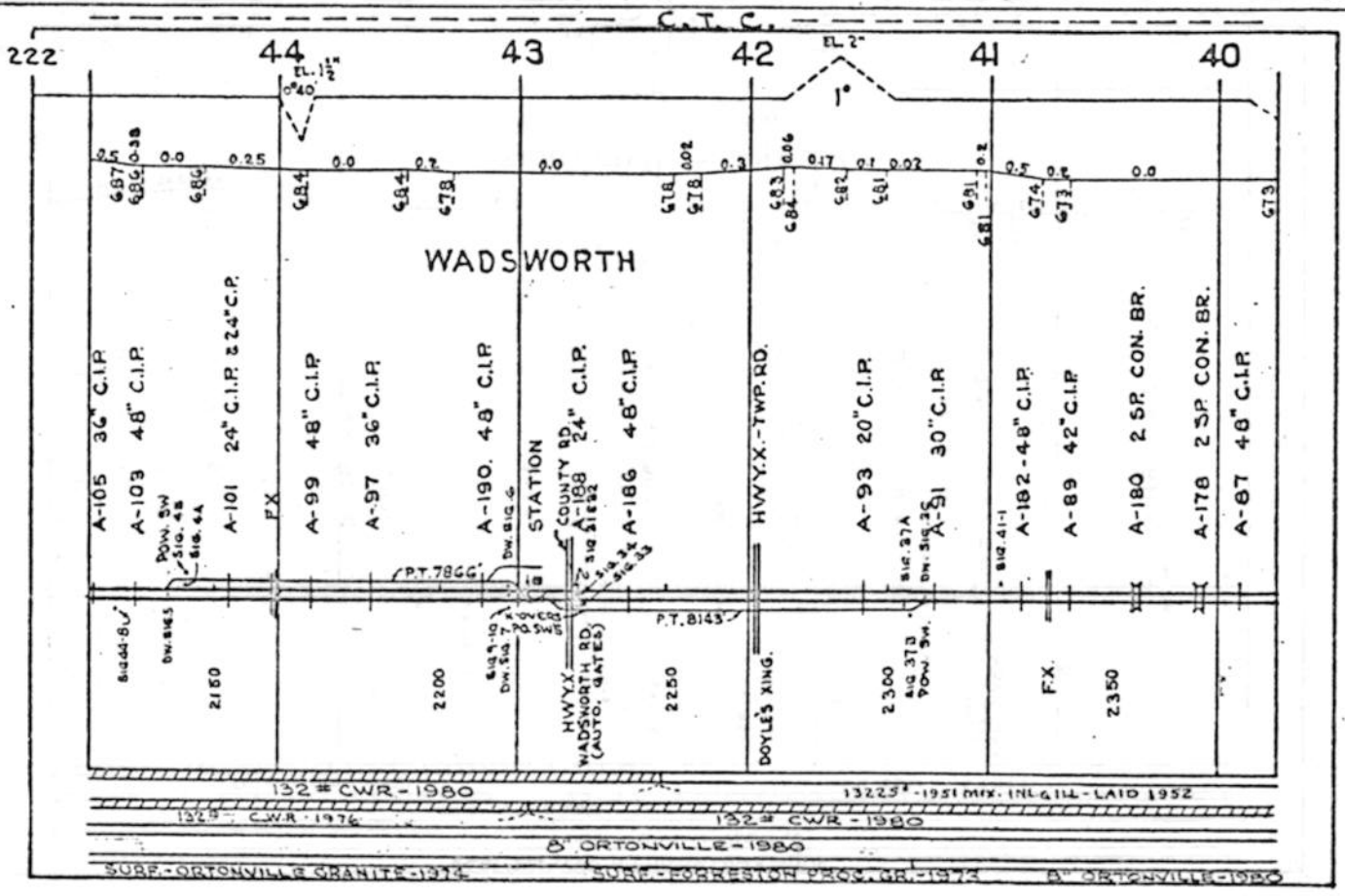

AUTOMATIC BLOCK SYSTEM

